

QBXE PE100 special stub flange

Stub flange in PE 100 SDR 11, short spigot for butt welding for exit side to be used with FR clapet valves.

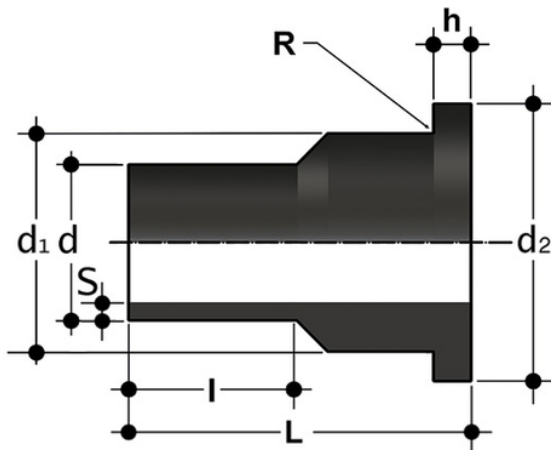

| Κωδικός προϊόντος | tooltplimage |
|-------------------|--------------|
| QBXE11050 | - |
| QBXE11063 | - |
| QBXE11075 | - |
| QBXE11090 | - |
| QBXE11110 | - |
| QBXE11125 | - |
| QBXE11140 | - |
| QBXE11160 | - |
| QBXE11180 | - |
| QBXE11200 | - |
| QBXE11225 | - |
| QBXE11250 | - |
| QBXE11280 | - |

QBXE PE100 special stub flange

- Upper part (PVC-U)
 - Bottom part (PVC-U)
 - Bolts (zinc plated steel)
 - Nuts (zinc plated steel)
 - Gasket (NBR)
 - Reinforcing ring (Stainless steel)
- The reinforcing bush are used to reinforce the pipe PE100 (SDR11) e PE-X, to elong the lifetime of the pipeline and to reduce the collapse risk of the pipe in disadvantages conditions. They use is particularly suggested using PE-X pipes. The two tightening keys (d.16-63 and d.75-110) are important tools to install the **MAGNUM 3G** fittings