

# MB

## Ηλεκτροσύνδεσμοι

Can also be used as repair couplers. With exposed heating coils for optimal heat transfer, large insertion depth, wide fusion zones plus cold zones at the end and in the middle to prevent the flow of molten material, for use without holding devices.

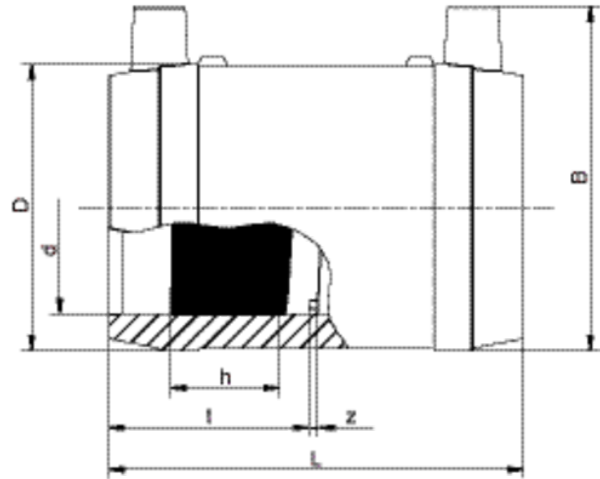

PE 100 SDR 11

Maximum working pressure 16 bar (water)/10 bar (gas)



Κωδικός προϊόντος	d	BX	PU	D	L	t	z	h	B	Weight kg
612680	20	110	3520	33	60	29	2	17	49	0,040
612681	25	90	2880	38	66	32	2	17	54	0,047
612682	32	60	1920	45	78	38	2	21	61	0,064
612683	40	40	1280	54	86	42	2	23	71	0,100
612684	50	25	800	68	98	48	2	27	82	0,150
612685	63	15	480	82	110	55	2	29	96	0,221
612686	75	50	400	98	122	60	3	32	110	0,360
612687	90	30	240	114	157	77	3	51	127	0,510
612688	110	24	192	137	159	78	3	49	152	0,710
612689	125	16	128	156	172	85	3	51	169	0,950
612690	140	12	96	174	184	91	3	52	185	1,270
612691	160	8	64	199	190	94	3	52	207	1,770

FRIALEN safety fittings can be fused to pipes SDR11 – SDR 17.6. Minimum wall thickness  $s_{min} \geq 3$  mm. Other SDR-stages on request. Please observe the marking directly at the product, which is mandatory. DVGW-Registration Nos. DV-8601AU2248 and DV-8606AU2249

# MB

## Ηλεκτροσύνδεσμοι

### Areas of Application

The FRIALEN-coupler MB is used for pipe connections when laying long runs. Additional areas of application:

- Integration of adapters into an existing pipe-line
- Connection of pipelines with fixed or restraint points
- Reinforcement / sealing of localised pipe damage
- Reinforcement of pinch points

### Assembly Instructions

The fusion of pipe ends with the FRIALEN-coupler MB takes place using FRIALEN-fusing – leakproof and longitudinally strong.

The pipe ends are prepared according to the general installation instructions (see "Assembly Instructions" for "FRIALEN-Safety Fittings for house connections and distribution pipes up to d 225"). This involves removing the oxide skin and cleaning the pipe ends. Please note that spigot of valves must be at least half as long as the coupler.

### Good reasons for using the FRIALEN-Coupler MB:

- Large coupler depth for ease of pipe guiding (no holding clamps required)
- Extra wide fusion zones
- Maximum stability through great wall thickness
- Cold zones at the front side and in the middle of the coupler
- Exposed heating coil for direct heat transmission to the pipe
- Small annular gap for build-up of optimum joining pressure in the fusion zone
- Touch proof electric contacts
- Fusion indicator for visual fusion control
- Durable batch marking
- Individually wrapped for dirt protection
- Additional barcode for tracing back the fitting (Traceability-Coding)