

# WUN 90

## Μεταβατική ηλεκτρογωνία 90° HD-PE/Brass

Compact transition fitting. HD-PE end with exposed heating coils for optimal heat transfer, large insertion depth, wide fusion zone plus cold zones at the end and in the transition area to prevent the flow of molten material for use without holding devices. Brass end permanently anchored in the HD-PE. Cannot be released or rotated. Self sealing patented sealing geometry without elastomer seal. For use in water systems.

Standard: Brass. Gunmetal on request.

Other thread sizes on request

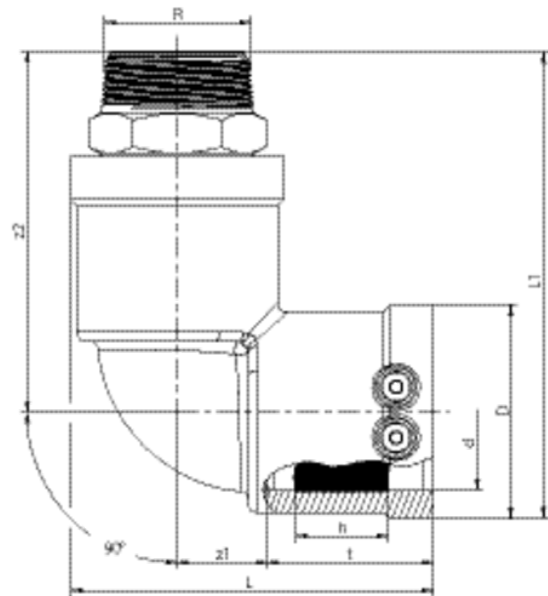

PE 100 SDR 11

Maximum working pressure 16 bar (water)



Κωδικός προϊόντος	d	BX	PU	D	R	L	t	z1	z2	h	Weight kg
612120	32	20	1000	47	1"	85	42	21	89	24	0,350
612140	32	20	800	47	1 1/2"	94	42	21	93	24	0,480
612127	40	15	750	58	1"	102	46	27	101	30	0,520
612122	40	15	750	58	1 1/4"	102	46	27	103	30	0,530
612121	40	15	750	58	1 1/2"	102	46	27	104	30	0,560
612119	50	10	500	70	1"	118	53	30	110	30	0,680
612123	50	10	500	70	1 1/4"	118	53	30	112	30	0,660
612124	50	10	500	70	1 1/2"	118	53	30	113	30	0,680
612125	63	10	320	84	1 1/2"	128	53	33	116	35	0,990
612126	63	10	320	84	2"	128	53	33	121	35	1,030

Other thread sizes on request

FRIALEN safety fittings can be fused to pipes SDR11 - SDR 17.6. Minimum wall thickness  $s_{min} \geq 3$  mm. Other SDR-stages on request. Please observe the marking directly at the product, which is mandatory. DVGW-Registration No. DV-7501AU2256

## WUN 90

### Μεταβατική ηλεκτρογωνία 90° HD-PE/Brass

Standard: Brass. Gunmetal and V2A on request

## WUN 90

### Μεταβατική ηλεκτρογωνία 90° HD-PE/Brass

#### Areas of Application

FRIALEN-Transition Elbows WUN 90° are threaded joints as an adaptor from a metal pipe with internal thread to a HD-PE pipe. Joint on the part of HD-PE by FRIALEN-Coupler.

#### Assembly Instructions

The threaded component must be held with a spanner to prevent it twisting in the HD-PE component. The fusion of the HD-PE side takes place by FRIALEN-fusing – leakproof and longitudinally strong.

The installation of the brass and the HD-PE side has to be prepared according to the general installation instructions (see "Transition Fittings with threaded connection" in "Assembly Instructions" for "FRIALEN-Safety Fittings for house connections and distribution pipes up to d 225"). This involves removing the oxide skin and cleaning the pipe ends.

#### Good reasons for using the FRIALEN-Transition Elbows WUN 90°:

Compact construction

HD-PE side with exposed heating element for optimal heat transfer

Cold zones at the end to prevent the flow of molten material

No holding clamps required

Large insertion depth, extra wide fusion zones

Brass end permanently anchored in the HD-PE and will not distort

Self sealing patented sealing geometry without elastomer seal

Additional barcode for tracing back the underground fitting (Traceability-Coding)