

WUN V2A 90

Μεταβατική ηλεκτρογωνία 90° HD-PE/Stainless steel

Compact transition fitting. HD-PE end with exposed heating coils for optimal heat transfer, large insertion depth, wide fusion zone plus cold zones at the end and in the transition area to prevent the flow of molten material for use without holding devices. Stainless steel end permanently anchored in the HD-PE. Cannot be released or rotated. Self sealing patented sealing geometry without elastomer seal. For use in water systems.

Other thread sizes on request

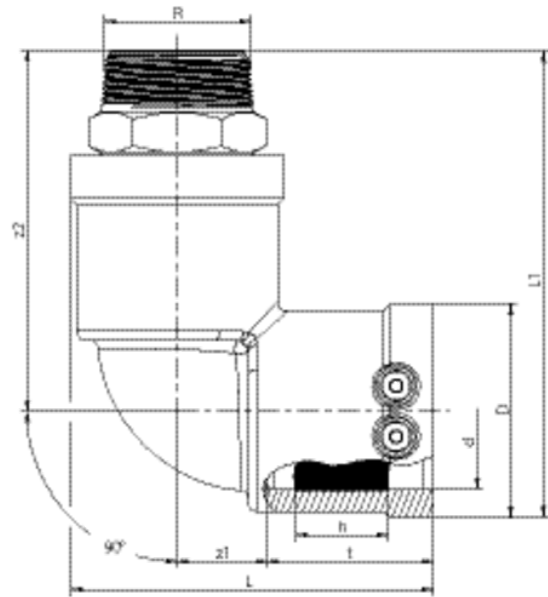

PE 100 SDR 11

Maximum working pressure 16 bar (water)



Κωδικός Προϊόντος	d	BX	PU	D	R	L	t	z ₁	z ₂	h	Weight kg
616514	40	15	750	58	1"	102	45,5	27	101	30	0,540
612148	40	15	750	58	1 1/2"	102	45,5	27	104	30	0,535
612118	50	10	600	70	1 1/2"	118	53	30	113	29,8	0,650
612186	63	10	320	84	1 1/2"	128	53	33	116	35	0,980
616515	63	10	320	84	2"	128	53	33	121	35	0,950

Other thread sizes on request

FRIALEN safety fittings can be fused to pipes SDR11 - SDR 17,6, minimum wall thickness $s_{min} \geq 3$ mm. Other SDR-stages on request. Please observe the marking directly at the product, which is mandatory.

DVGW-Registration Nos. DV-7501AU2256 and DV-7501AU2257

WUN V2A 90

Μεταβατική ηλεκτρογωνία 90° HD-PE/Stainless steel

Areas of Application

FRIALEN-Transition Elbows WUN-V2A 90° are threaded joints as an adaptor from a metal pipe with internal thread to a HD-PE pipe. Joint on the part of HDPE by FRIALEN-Coupler. The threaded joint is made of stainless steel (Material St. 1.4305 / X8CrNiS18-9).

Assembly Instructions

During assembly, only a spanner applied to the provided metal hexagon must be used to screw the component into its metal counterpart. The fusion of the HD-PE side takes place by FRIALEN-fusing – leakproof and longitudinally strong.

The installation of the stainless steel and the HD-PE side has to be prepared according to the general installation instructions (see "Transition Fittings with threaded connection" in "Assembly Instructions" for "FRIALEN-Safety Fittings for house connections and distribution pipes up to d 225"). This involves removing the oxide skin and cleaning the pipe ends.

Good reasons for using the FRIALEN-Transition Elbows WUN-V2A 90°:

Compact construction

HD-PE side with exposed heating element for optimal heat transfer

Cold zones at the end to prevent the flow of molten material

No holding clamps required

Large insertion depth, extra wide fusion zones

Stainless steel end permanently anchored in the HD-PE and will not distort

Self sealing patented sealing geometry without elastomer seal

Additional barcode for tracing back the underground fitting (Traceability-Coding)

Threaded joint made of stainless steel (St. 1.4305) = resistant to corrosion

Suitable for usage in high humidity environment or in industrial area