

# ASA UNI

## Σέλα Spigot ASA UNI SDR 17

For integration of a branch line in PE pipelines – unpressurised or under operating pressure. Compact fitting made of HD-PE. Saddle with exposed heating element for optimal heat transfer. Outlet spigot for processing with FRIALEN couplers MB or UB. Suitable for all pipe diameters in the given range.

For variable adaptation to all pipe diameters in the specified range by means of clamping device UNITOP (Ref.-No. 613385) and clamping adapter for outlet SDR 17 (Ref.-No. 613839). Tapping in unpressurised condition using the FRIATOOLS drilling equipment FWAB XL 160 (see application picture and product range FRIATOOLS Ref.-No. 613838) for ASA UNI.

With indicator for visually checking fusion.

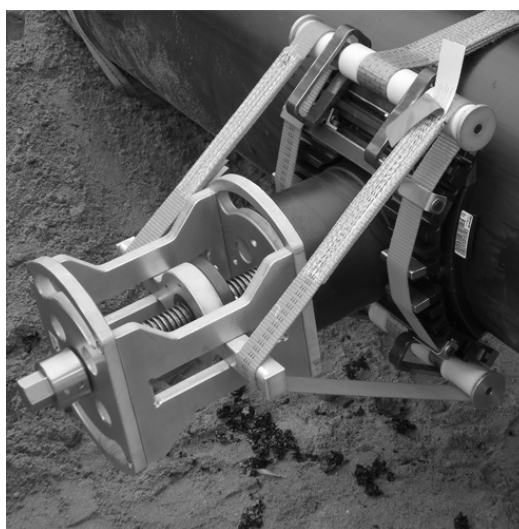
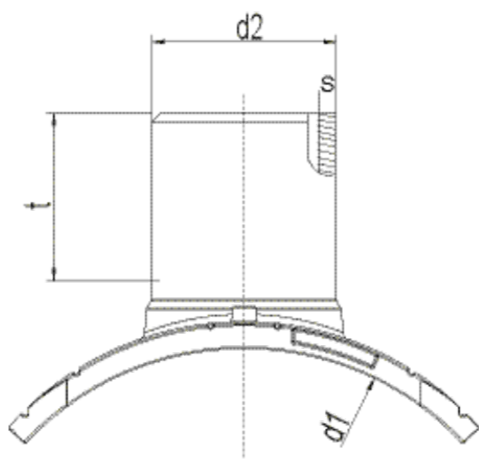

PE 100 SDR 11

Maximum working pressure 2,5 bar (sewage)

Κωδικός Προϊόντος	product.detail.attribute.d1Small	d <sub>2</sub>	BX	PU	Weight kg
682639	630-900	160	5	40	1,570

# ASA UNI

## Σέλα Spigot ASA UNI SDR 17

### Areas of Application

Instead of cost-intensively integrating a T-piece, a branch or vent can be very comfortably created using the FRIALEN spigot saddle SA-UNI. The spigot outlet can be fused with FRIALEN couplers MB or UB.

### Assembly Instructions

The saddle is clamped onto the pipe with the UNITOP clamping device (see FRIATOOLS product range). The clamping device UNITOP is an universal tool for all SA-UNI dimensions. Please read the assembly and operating instructions for the clamping device UNITOP.

The fusion of the HD-PE distribution pipes and the house connections with FRIALEN-Spigot Saddles SA-UNI takes place by FRIALEN-fusing – leakproof and longitudinally strong.

The saddle and the outlet spigot have to be prepared according to the general installation instructions (see assembly instruction FRIALEN-XL for laying large pipes and relining pipe networks). This involves removing the oxide skin and cleaning the pipe covered by the saddle.

For tapping of pipes without pressure please use the

FRIATOOLS tapping equipment FWAB XL. Please refer the assembly and operating instructions of the drilling device FWAB XL / FWAB ASA. The fusion and tapping of pipes under pressure is possible with special tapping equipment. Please contact our applications engineers.

### Good reasons for using the

#### FRIALEN Spigot Saddle SA-UNI:

Compact construction

HD-PE saddle with exposed heating element for optimal heat transfer

Low tapping forces

Burr-free and almost flush tapping for maximum hydraulic performance

Leakage free tapping possible by means of a shut off element

Extra wide fusion zone

Additional barcode for tracing back the underground fitting (Traceability-Coding)

Before tapping the pipe a leak test can take place with the pressure testing device (FWDPA SA)

Touch proof electric contacts

Easy and safe assembly by top-loading with the UNITOP clamping device.

Fusion indicators for visual fusion control

Durable batch marking

Individually wrapped for dirt protection