

ABM

Ηλεκτροσύνδεσμος υπό γωνία

for change of direction in HDPE sewage connection pipes and connection to sewage saddles ASA-TL

Little space required thanks to compact design as well as angle spacings of 15°, 30°, 45° facilitate a comfortable pipeline routing. Fusion couplers integrated on both ends to reduce the assembly time with exposed heating coils for an optimal heat transfer. The smooth, hydraulically optimised internal contour offers a level passage when pipes SDR 17/17.6 are used. The bright surface facilitates an optimal view during camera inspection. With pin indicator for visually checking fusion

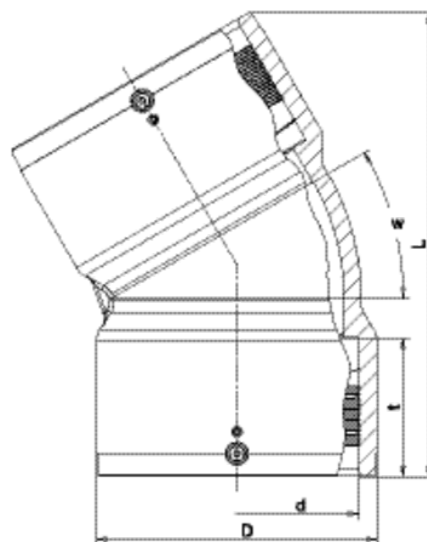

PE 100

Maximum working pressure 2,5 bar

Κωδικός προϊόντος	w	d	BX	PU	D	L	t	Weight kg
681100	15°	160	6	48	185	279	92	1,870
681101	30°	160	6	48	185	306	92	2,100
681102	45°	160	6	48	185	320	92	2,060

ABM

Ηλεκτροσύνδεσμος υπό γωνία

Sewage pipe systems are high-value assets of a value which has to be maintained for a long time. Increasing demands on the public sewage system require materials which meet these criteria. HDPE sewage pipes have been fused for many years with the FRIAFIT HDPE sewage system tightly, frictionlocked and root-proof.

AREAS OF APPLICATION

The FRIAFIT elbows ABM and ABMS d 160/DN 150 are used for change of direction in sewage and combined sewage water connection lines. The types ABM (coupler/coupler) or ABMS (coupler/pipe spigot) and the angle spacings 15°, 30° and 45° facilitate a comfortable piping configuration. Angles of 60°, 90° etc. can be produced by using multiple elbows. The FRIAFIT elbow ABMS is specifically suited for direct fusion into the FRIAFIT sewage saddle ASA-TL. The FRIAFIT elbows ABM and ABMS have a smooth, hydraulically optimised internal contour for sewage water draining and offer a level passage when used with

pipes SDR 17/17.6. The bright surface facilitates an optimal view during camera inspection. The material used is stabilised against UV radiation.

NOTES ON PROCESSING

The connection of the pipes and fittings with FRIAFIT elbows by FRIAFIT fusion is leak-tight and friction-locked. The PE fusion ends of the pipe or fitting are prepared according to the general installation

requirements (see assembly instructions for the FRIAFIT sewage system) (remove oxide layer/clean). For push-fit connections at the pipe spigot of the FRIAFIT elbow ABMS, insertion depths and wall

thickness differences, if any, are to be considered.

Good reasons for the FRIAFIT elbows ABM / ABMS

Little space required thanks to compact design

Reduction of the installation time thanks to

integrated fusion couplers

Large coupler depths for good guiding of the

pipe or pipe spigot (no fixing devices required)

Leak-tight, friction-locked and root-proof connection

Exposed, fixed heating coil for direct heat transfer to the pipe

Extra-broad fusion zones

Extra-large insertion depths

Short fusion times, short cooling down times

Fusion indicator for visual control of fusion

Extra-long cold zones before and after the fusion area

Barcode for fully automatic fusion with HDPE pipes from SDR 33 to SDR 17, taking into consideration the ambient temperature (temperature compensation)

Bright component part interior surface for continuous camera inspection

ABM

Ηλεκτροσύνδεσμος υπό γωνία

Hydraulically optimised internal contour through curved form

Level when using SDR 17/17.6 connecting pipes, no drain obstructions

Flexible use thanks to types ABM (coupler/coupler) or ABMS (coupler/pipe spigot)

Elbow angle 15°, 30°, and 45°

Other elbow angles can be produced by using multiple elbows or combining elbows