

CMDC/CP NC – pneumatically actuated compact diaphragm valve DN 12:15

Pneumatically actuated diaphragm valve with metric plain spigot ends for solvent welding, Normally Closed.

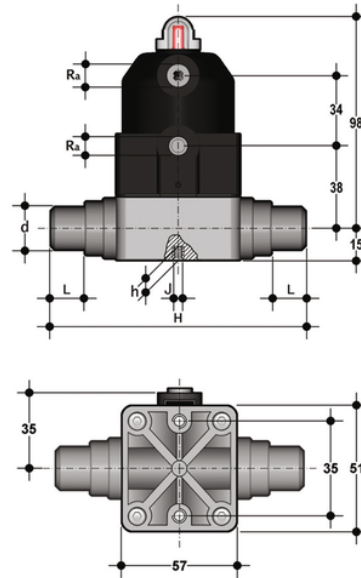

EPDM

Κωδικός Προϊόντος

CMDCNC020E

FKM

Κωδικός Προϊόντος

CMDCNC020F

PTFE

Κωδικός Προϊόντος

CMDCNC020P