

RFV

Reducer with BSP threaded male end (R) and BSP threaded female end (R1 reduced) (fig. A)

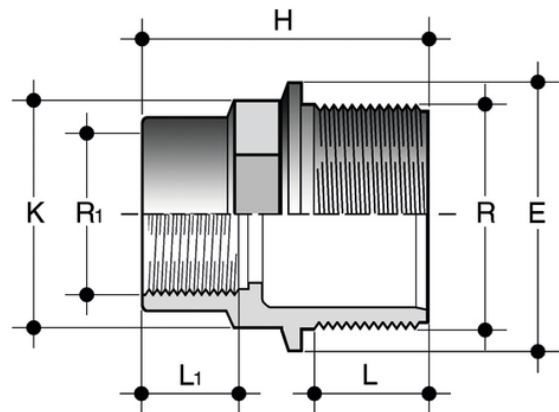

Fig. A

Κωδικός προϊόντος	tooltiplmage	R x R[5:1]	PN	E	H	K	L	L[5:1]	g
RFV012038	-	1/2" x 3/8"	16	28	35	23	15	11,4	10
RFV200114	-	2" x 1 1/4"	16	70	65	64	25,7	21,4	85
RFV200100	-	2" x 1"	16	70	63	64	25,7	19,1	80
RFV200034	-	2" x 3/4"	16	70	60	64	25,7	16,3	80
RFV112114	-	1 1/2" x 1 1/4"	16	58	57	51	21,4	21,4	54
RFV112100	-	1 1/2" x 1"	16	58	55	51	21,4	19,1	52
RFV112034	-	1 1/2" x 3/4"	16	58	50	51	21,4	16,3	47
RFV112012	-	1 1/2" x 1/2"	16	58	52	51	21,4	15	46
RFV114100	-	1 1/4" x 1"	16	52	52	44	21,4	19,1	40
RFV114034	-	1 1/4" x 3/4"	16	52	49	44	21,4	16,3	37
RFV114012	-	1 1/4" x 1/2"	16	52	48	44	21,4	15	37
RFV100034	-	1" x 3/4"	16	40	46	35	19,1	16,3	25
RFV100012	-	1" x 1/2"	16	40	44	35	19,1	15	24
RFV100038	-	1" x 3/8"	16	40	41	35	19,1	11,4	20
RFV034012	-	3/4" x 1/2"	16	34	39	28	16,3	15	15
RFV034038	-	3/4" x 3/8"	16	34	36	28	16,3	11,4	12
RFV200112	-	2" x 1 1/2"	16	70	65	64	25,7	21,4	102