

MR STOP

Electrofusion reducers with integrated Maxitrol excess flow valve

Reducer MR with integrated SENTRY GS safety equipment which automatically shuts down gas flow in the event of pipe damage caused e.g. by digging or drilling. Exposed heating coils for optimum heat transfer, large insertion depth, wide fusion zones as well as cold zones preventing molten material escape at the front and in the centre for processing without holding device. The universal type Z meets all practical requirements of the operating pressure range and the required flow quantity. Type D and Z with overflow.

The product is suitable from up to 20 % hydrogen.

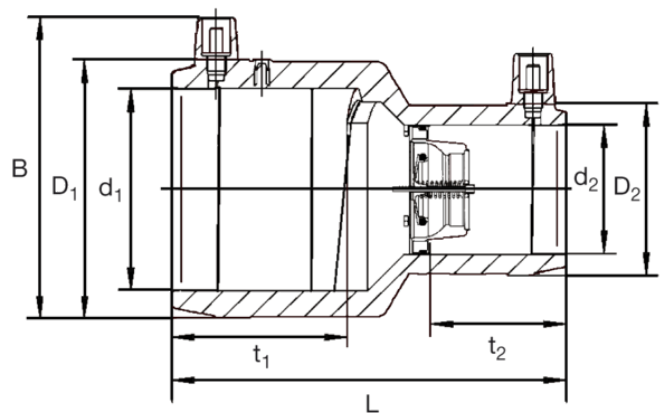

PE 100 SDR 11

Maximum working pressure Type Z: 5 bar (gas), Type D: 1 bar (gas)



Κωδικός Προϊόντος	product.detail.attribute.d1Small	d ₂	BX	PU	L	t ₁	t ₂	D ₁ D ₂	Operating pressure range p _{min} - P _{max}	VN	Weight kg
616218	50	40	12	600	110	49	37	68/54	35 mbar - 5 bar	26 - 62	0,210
616219	63	32	18	576	125	55	44	82/45	35 mbar - 5 bar	17 - 40	0,240
616220	63	40	8	400	125	55	40	82/54	35 mbar - 5 bar	26 - 62	0,290
616221	63	50	8	400	125	55	47	82/68	35 mbar - 5 bar	41 - 99	0,360
616238	63	32	10	500	125	55	44	82/45	25 mbar - 1 bar	11 - 16	0,240
616240	63	50	16	512	125	55	47	82/68	25 mbar - 1 bar	28 - 40	0,360

The universal type Z meets the practical requirements of the operating pressure range and the necessary flow quantity.

Type D, Z: Maxitrol with overflow device, max. overflow quantity D: 30 l/h at 100 mbar, Z: 30 l/h at 1 bar.

p_{min} - p_{max}: min - max operating pressure or Maxitrol initial pressure.

MR STOP

Electrofusion reducers with integrated Maxitrol excess flow valve

VN: nominal flow at p_{\min} – p_{\max} in relation to natural gas $d = 0.6$ at standard conditions (1013 mbar, 15 °C) in m^3/h .

MR STOP

Electrofusion reducers with integrated Maxitrol excess flow valve

Area of Application

MR-STOPP is used for gas service lines according to DVGW G459-1-appendix (12/03) for operating pressure ranging from 25 mbar – 5 bar. The MR-STOPP is a FRIALEN reducer coupler with integrated excess flow valve which automatically shuts off the gas flow in the event of pipe damage leading to leaking of gas, caused e.g. by dredging or drilling. The MR-STOPP is best installed into the branch between main and service line, directly behind the tapping valve. The Maxitrol type selection takes place according to the minimal operating pressure of the network and the flow output required by the consumer. The Universal Type Z meets perfectly the practical requirements of the operating pressure range and the necessary flow quantity.

Operation

(see also leaflets on technical data by Maxitrol "SENTRY GS gas flow monitor for underground external networks") The MR-STOPP is subdivided into types D or Z according to mains pressure range. It shuts off automatically at a defined gas flow as typically occurs where there is damage to the gas service line. The gas flow is stopped immediately and completely. Types D and Z have overflow devices. This overflow quantity allows the pressure in the undamaged gas pipe to increase again in order for the excess flow valve to re-open automatically. Type D, Z: Maxitrol with overflow device: overflow quantities of over 30 l/h require additional passive safety measures in the building according to DVGW-G459-1-B.

Processing Advice

The MR-STOPP is to be processed according to the operation and installation instructions which come with each MR-STOPP. Installation always takes place in the direction of the flow of the medium going from larger to smaller dimensions. The flow direction is marked by arrowson the label. Pressure testing of the gas route using MR-STOPP is authorised up to 10 bar air with the gas flow monitor open.

Operational mains pressure of the component is printed on the type label:

- Yellow type label (type Z) for 35 mbar up to 5 bar
- Orange type label (type D) for 25 mbar up to 1 bar

DVGW test symbols awarded:

reducer coupler MR = DV-8601AU2248. Gas flow monitor = DG-4360BO0438.

The use of this component can be marked in the area of the main shut-off device of the building (appropriate ID card including markings of product data and batches are all included in the initial delivery). FRIALEN safety fittings may be welded with pipes of SDR levels 11. Welding MR STOPP with HD-PE service pipe system takes place using FRIALEN-fusion – tight and with axial force. Installation is prepared according to the general installation requirements (see also "Installation instructions for FRIALEN safety fittings for service and distributor lines up to d 225) (remove oxidic layer/clean).

Good reasons for MR-STOPP:

Factory made combination of FRIALEN MR reducer coupler and Maxitrol excess flow valve

Especially important with reducer couplers: triple centre stop provides maximum protection from expressing / position shifting

The shortening the cold zones through integrated GS is compensated as opposed to the standard coupler

Exposed heating coil and wide fusion zones allow optimum heat transfer

Additional barcode for traceability of excess flow valve and coupler (traceability coding)

Excess Flow Valve

MR STOP

Electrofusion reducers with integrated Maxitrol excess flow valve

has been individually function checked and adjusted precisely by the factory

has low pressure loss

is largely resistant to contaminations in the gas

its principle has been tried and tested for years

tolerates pressure increase from low to medium pressure in suitable network

Type Z can be applied universally from 35 mbar to 5 bar, simple storage, no risk of mix-ups, low operational training needs