

RS

Σέλα επιδιόρθωσης

Compact fitting manufactured from 2 HD-PE saddles for the repair of minor pipe damage. With exposed heating elements for optimal heat transfer.

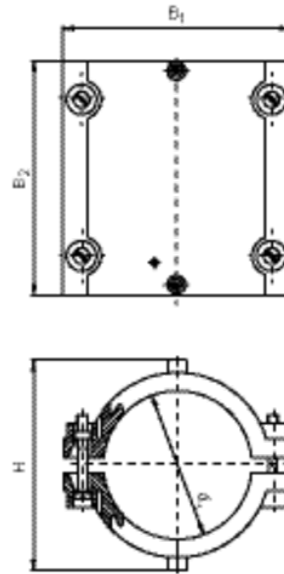

RS

Σέλα επιδιόρθωσης

Areas of Application

The FRIALEN-Reinforcing Saddles are used for the repair of minor pipe damage with no escape of fluid, especially to reinforce crushed zones and points with external damage.

Assembly Instructions

The fusion of the HD-PE pipe with the FRIALEN-Reinforcing Saddles takes place by FRIALEN-fusing – leakproof and longitudinally strong.

Both HD-PE saddles have to be prepared according to the general installation instructions (see "Assembly Instructions" for "FRIALEN-Safety Fittings for house connections and distribution pipes up to d 225"). This involves removing the oxide skin and cleaning the pipe covered by the saddles.

Good reasons for using the FRIALEN-RS:

Compact construction

HD-PE saddle with exposed heating element for optimal heat transfer

Preassembled unit without loose parts

Extra wide fusion zone

Additional barcode for tracing back the underground fitting (Traceability-Coding)