

# QDE SDR17 - Stub flange

Stub flange, long spigot, for butt welding for ISO/DIN backing rings SDR 17 -S 8.

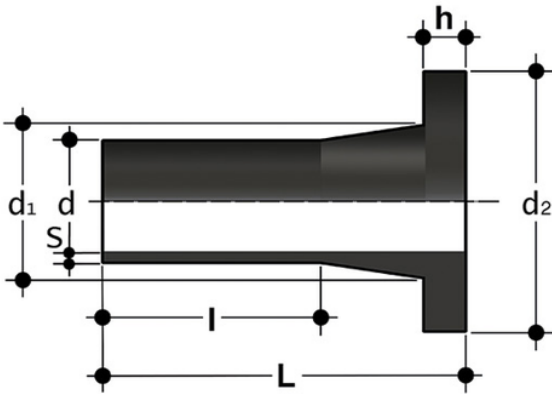

Reference	tooltipImage	product.detail.attribute.textBelowTableText	system	Category	family	series	d	h	l	d <sub>1</sub>	d <sub>2</sub>
QDE17050	-	* resale products	PE Pipe and Fittings	Pressure Fittings	ISO-UNI Fittings	Long-spigot-for-butt-welding-and-electrofusion	*50	12	62	60	88
QDE17063	-	* resale products	PE Pipe and Fittings	Pressure Fittings	ISO-UNI Fittings	Long-spigot-for-butt-welding-and-electrofusion	*63	14	70	75	102
QDE17075	-	* resale products	PE Pipe and Fittings	Pressure Fittings	ISO-UNI Fittings	Long-spigot-for-butt-welding-and-electrofusion	*75	16	90	89	122
QDE17090	-	* resale products	PE Pipe and Fittings	Pressure Fittings	ISO-UNI Fittings	Long-spigot-for-butt-welding-and-electrofusion	*90	17	100	105	138
QDE17110	-	* resale products	PE Pipe and Fittings	Pressure Fittings	ISO-UNI Fittings	Long-spigot-for-butt-welding-	*110	18	113	125	158



# QDE SDR17 – Stub flange

Reference	tooltipImage	product.detail.attribute.textBelowTableText	system	Category	family	series	d	h	l	d <sub>1</sub>	d <sub>2</sub>
QDE17125	-	* resale products	PE Pipe and Fittings	Pressure Fittings	ISO-UNI Fittings	and-electrofusion Long-spigot-for-butt-welding-and-electrofusion	*125	18	122	132	158
QDE17140	-	* resale products	PE Pipe and Fittings	Pressure Fittings	ISO-UNI Fittings	Long-spigot-for-butt-welding-and-electrofusion	*140	18	130	153	188
QDE17160	-	* resale products	PE Pipe and Fittings	Pressure Fittings	ISO-UNI Fittings	Long-spigot-for-butt-welding-and-electrofusion	*160	18	160	175	212
QDE17180	-	* resale products	PE Pipe and Fittings	Pressure Fittings	ISO-UNI Fittings	Long-spigot-for-butt-welding-and-electrofusion	*180	20	140	186	212
QDE17200	-	* resale products	PE Pipe and Fittings	Pressure Fittings	ISO-UNI Fittings	Long-spigot-for-butt-welding-and-electrofusion	*200	24	133	232	268
QDE17225	-	* resale products	PE Pipe and Fittings	Pressure Fittings	ISO-UNI Fittings	Long-spigot-for-butt-welding-and-electrofusion	*225	24	135	235	268
QDE17250	-	* resale products	PE Pipe and Fittings	Pressure Fittings	ISO-UNI Fittings	Long-spigot-for-butt-welding-and-electrofusion	*250	25	148	285	320
QDE17280	-	* resale products	PE Pipe and Fittings	Pressure Fittings	ISO-UNI Fittings	Long-spigot-for-butt-welding-and-electrofusion	*280	25	154	291	320





# QDE SDR17 - Stub flange

Reference	tooltiplmage	product.detail.attribute.textBelowTableText	system	Category	family	series	d	h	l	d <sub>1</sub>	d <sub>2</sub>
QDE17315	-	* resale products	PE Pipe and Fittings	Pressure Fittings	ISO-UNI Fittings	Long-spigot-for-butt-welding-and-electrofusion	*315	25	166	335	370
QDE17355	-	* resale products	PE Pipe and Fittings	Pressure Fittings	ISO-UNI Fittings	Long-spigot-for-butt-welding-and-electrofusion	*355	30	179	373	430
QDE17400	-	* resale products	PE Pipe and Fittings	Pressure Fittings	ISO-UNI Fittings	Long-spigot-for-butt-welding-and-electrofusion	*400	33	195	427	482
QDE17450	-	* resale products	PE Pipe and Fittings	Pressure Fittings	ISO-UNI Fittings	Long-spigot-for-butt-welding-and-electrofusion	*450	46	225	515	585
QDE17500	-	* resale products	PE Pipe and Fittings	Pressure Fittings	ISO-UNI Fittings	Long-spigot-for-butt-welding-and-electrofusion	*500	46	240	532	585
QDE17560	-	* resale products	PE Pipe and Fittings	Pressure Fittings	ISO-UNI Fittings	Long-spigot-for-butt-welding-and-electrofusion	*560	50	250	616	685
QDE17630	-	* resale products	PE Pipe and Fittings	Pressure Fittings	ISO-UNI Fittings	Long-spigot-for-butt-welding-and-electrofusion	*630	50	270	644	685
QDE17710	-	* resale products	PE Pipe and Fittings	Pressure Fittings	ISO-UNI Fittings	Long-spigot-for-butt-welding-and-electrofusion	*710	50	280	737	800
QDE17800	-	* resale products	PE Pipe	Pressure Fittings	ISO-UNI Fittings	Long-spigot-for-butt-welding-	*800	52	294	840	905





# QDE SDR17 - Stub flange

Reference	tooltipImage	product.detail.attribute.textBelowTableText	system	Category	family	series	d	h	l	d <sub>1</sub>	d <sub>2</sub>
			and Fittings			and-electrofusion					



## QDE SDR17 – Stub flange

- Size range:  $d 12 \div d 800$  (mm)
- Nominal pressure: SDR 17 (PN10) with water at 20 °C, SDR 11 (PN16) with water at 20 °C
- Temperature range:  $-40 \text{ °C} \div 60 \text{ °C}$
- Coupling standards – Reference standards:
  - Welding: EN ISO 15494. Can be coupled to pipes according to EN ISO 15494
  - Flanging system: ISO 7005-1, EN 1092-1, EN ISO 15494, ANSI B16.5 cl.150
  - Construction criteria: UNI EN ISO 15494
  - Test methods and requirements: UNI EN ISO 15494
  - Installation criteria: DVS 2202-1, DVS 2207-1, UNI EN 12201- 3, UNI 10520, ISO 21307, UNI 10521, UNI EN 1555-3, ISO 4427- 3, ISO 4437-3
- Fitting material: PE-HD
- Seal material: EPDM, FKM