

OKDB - Profile backing ring PP

Profile backing ring PP with cast iron core according to DIN standard. Drilled: PN 10/16 up to d180, PN10 from d200 to d630.

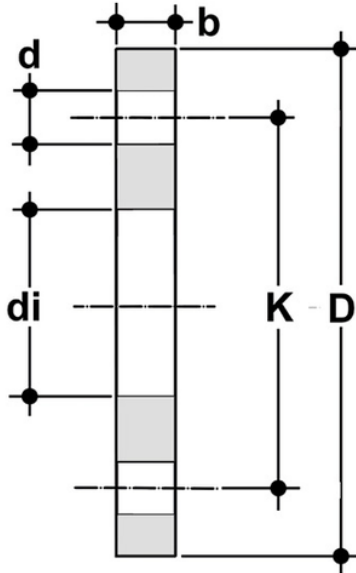

Reference	tooltipImage	product.detail.attribute.textBelowTableText	system	Category	d	DN	**PMA (bar)	b	D	d	K	M
OKDB032	-	*resale products **PMA: maximum allowable pressure ***n: number of bolts	Special parts and accessories	Flanges	*32	25	16	18	122	14,5	85	M
OKDB040	-	*resale products **PMA: maximum allowable pressure ***n: number of bolts	Special parts and accessories	Flanges	*40	32	16	18	142	18	100	M
OKDB050	-	*resale products **PMA: maximum allowable pressure ***n: number of bolts	Special parts and accessories	Flanges	*50	40	16	19	155	18	110	M
OKDB063	-	*resale products **PMA: maximum allowable pressure ***n: number of bolts	Special parts and accessories	Flanges	*63	50	16	20	170	18	125	M
OKDB075	-	*resale products **PMA: maximum allowable pressure ***n: number of bolts	Special parts and accessories	Flanges	*75	65	16	21	191	18	145	M
OKDB090	-	*resale products **PMA: maximum allowable pressure ***n: number of bolts	Special parts and accessories	Flanges	*90	80	16	21	206	18	160	M
OKDB110	-	*resale products **PMA: maximum allowable pressure ***n: number of bolts	Special parts and accessories	Flanges	*110	100	16	22	226	18	180	M
OKDB125	-	*resale products **PMA: maximum allowable pressure ***n: number of bolts	Special parts and accessories	Flanges	*125	100	16	23	226	18	180	M



OKDB – Profile backing ring PP

Reference	tooltiplmage	product.detail.attribute.textBelowTableText	system	Category	d	DN	**PMA (bar)	b	D	d	K	M
OKDB140	-	*resale products **PMA: maximum allowable pressure ***n: number of bolts	Special parts and accessories	Flanges	*140	125	16	25	256	18	210	M
OKDB160	-	*resale products **PMA: maximum allowable pressure ***n: number of bolts	Special parts and accessories	Flanges	*160	150	16	28	291	22	240	M
OKDB180	-	*resale products **PMA: maximum allowable pressure ***n: number of bolts	Special parts and accessories	Flanges	*180	150	16	27	291	22	240	M
OKDB200	-	*resale products **PMA: maximum allowable pressure ***n: number of bolts	Special parts and accessories	Flanges	*200	200	16	29	346	22	295	M
OKDB225	-	*resale products **PMA: maximum allowable pressure ***n: number of bolts	Special parts and accessories	Flanges	*225	200	16	29	346	22	295	M
OKDB250	-	*resale products **PMA: maximum allowable pressure ***n: number of bolts	Special parts and accessories	Flanges	*250	250	16	31	404	22	350	M
OKDB280	-	*resale products **PMA: maximum allowable pressure ***n: number of bolts	Special parts and accessories	Flanges	*280	250	16	31	404	22	350	M
OKDB315	-	*resale products **PMA: maximum allowable pressure ***n: number of bolts	Special parts and accessories	Flanges	*315	300	16	40	456	22	400	M
OKDB355	-	*resale products **PMA: maximum allowable pressure ***n: number of bolts	Special parts and accessories	Flanges	*355	350	16	55	521	22	460	M
OKDB400	-	*resale products **PMA: maximum allowable pressure ***n: number of bolts	Special parts and accessories	Flanges	*400	400	16	57,5	584	26	515	M
OKDB450	-	*resale products **PMA: maximum allowable pressure ***n: number of bolts	Special parts and accessories	Flanges	*450	400	10	56	690	26	620	M
OKDB500	-	*resale products **PMA: maximum allowable pressure ***n: number of bolts	Special parts and accessories	Flanges	*500	500	10	56	690	26	620	M
OKDB560	-	*resale products **PMA: maximum allowable pressure ***n: number of bolts	Special parts and accessories	Flanges	*560	600	10	64	804	30	725	M
OKDB630	-	*resale products **PMA: maximum allowable pressure ***n: number of bolts	Special parts and accessories	Flanges	*630	600	10	64	804	30	725	M

