

# MB SDR 11

## Coupler with easily removable inner stop, SDR 11

Coupler MB SDR 11 with inner stop

- Gas, water and H<sub>2</sub>
- Maximum pressure: Gas 10 bar, Water 16 bar
- Material: PE 100
- Easily removable inner stop
- Safety technology
- Large insertion depth for good pipe routing (no holding devices required)
- DVGW test mark: DV-8601AU2248 and DV-8606AU2249

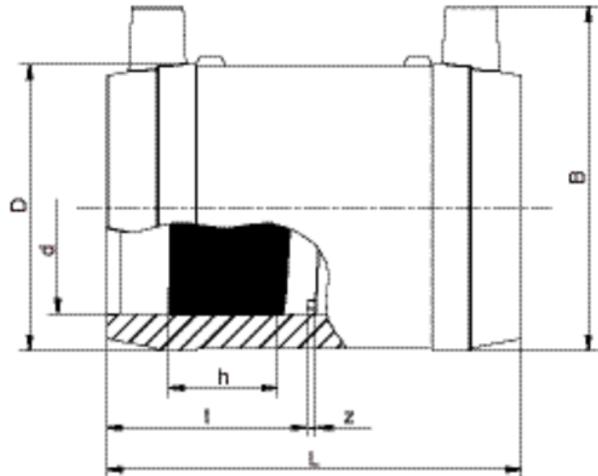

PE 100 SDR 11

Maximum permissible working pressure 16 bar (water) / 10 bar (gas)



Reference	d	BX	PU	D	L	t	z	h	B	Weight kg
612680	20	110	3520	33	60	29	2	17	49	0,040
612681	25	90	2880	38	66	32	2	17	54	0,047
612682	32	60	1920	45	78	38	2	21	61	0,064
612683	40	40	1280	54	86	42	2	23	71	0,100
612684	50	25	800	68	98	48	2	27	82	0,150
612685	63	15	480	82	110	55	2	29	96	0,221
612686	75	50	400	98	122	60	3	32	110	0,360
612687	90	30	240	114	157	77	3	51	127	0,510
612688	110	24	192	137	159	78	3	49	152	0,710
612689	125	16	128	156	172	85	3	51	169	0,950
612690	140	12	96	174	184	91	3	52	185	1,270
612691	160	8	64	199	190	94	3	52	207	1,770

# MB SDR 11

## Coupler with easily removable inner stop, SDR 11

FRIALEN safety fittings can be fused with SDR11 - SDR17.6 pipes. Other levels of SDR can be processed on request. Please note the mandatory labels directly on the product. DVGW test marks issued: DV-8601AU2248 and DV-8606AU2249

# MB SDR 11

## Coupler with easily removable inner stop, SDR 11

### Areas of Application

The FRIALEN-coupler MB is used for pipe connections when laying long runs. Additional areas of application:

- Integration of adapters into an existing pipe-line
- Connection of pipelines with fixed or restraint points
- Reinforcement / sealing of localised pipe damage
- Reinforcement of pinch points

### Assembly Instructions

The fusion of pipe ends with the FRIALEN-coupler MB takes place using FRIALEN-fusing – leakproof and longitudinally strong.

The pipe ends are prepared according to the general installation instructions (see "Assembly Instructions" for "FRIALEN-Safety Fittings for house connections and distribution pipes up to d 225"). This involves removing the oxide skin and cleaning the pipe ends. Please note that spigot of valves must be at least half as long as the coupler.

### Good reasons for using the FRIALEN Coupler MB:

- Large coupler depth for ease of pipe guiding (no holding clamps required)
- Extra wide fusion zones
- Maximum stability through great wall thickness
- Cold zones at the front side and in the middle of the coupler
- Exposed heating coil for direct heat transmission to the pipe
- Small annular gap for build-up of optimum joining pressure in the fusion zone
- Touch proof electric contacts
- Fusion indicator for visual fusion control
- Durable batch marking
- Individually wrapped for dirt protection
- Additional barcode for tracing back the fitting (Traceability-Coding)