

WUN 90

90° transition elbow HD-PE/brass with external thread

Transition elbow brass pipe WUN 90

- Water
- Maximum pressure: Water 16 bar
- Material: PE 100 and brass (EN 12168 - CW617N, thread according to EN 10226-1)
- Safety technology

Note:

The brass side is anchored as non-detachable and non-rotatable in PE.

Self-sealing, patented sealing geometry without elastomeric seal for utilisation in water areas.

Default: Brass, gunmetal on request.

Other thread dimensions available on request.

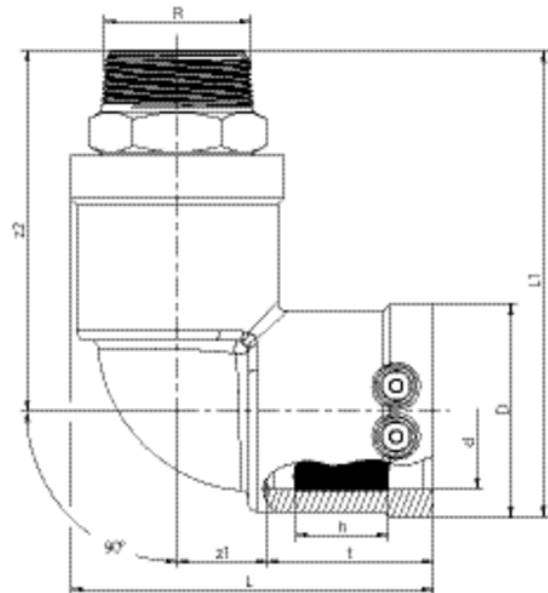

PE 100 SDR 11

Maximum permissible working pressure 16 bar (water)



Reference	d	BX	PU	D	R	L	t	z1	z2	h	Weight kg
612120	32	20	1000	47	1"	85	42	21	89	24	0,340
612140	32	20	800	47	1 1/2"	94	42	21	93	24	0,470
612127	40	15	750	58	1"	102	46	27	101	30	0,500
612122	40	15	750	58	1 1/4"	102	46	27	103	30	0,520
612121	40	15	750	58	1 1/2"	102	46	27	104	30	0,560
612119	50	10	500	70	1"	118	53	30	110	30	0,680
612123	50	10	500	70	1 1/4"	118	53	30	112	30	0,670
612124	50	10	500	70	1 1/2"	118	53	30	113	30	0,680

WUN 90

90° transition elbow HD-PE/brass with external thread

Reference	d	BX	PU	D	R	L	t	z ₁	z ₂	h	Weight kg
612125	63	10	320	84	1 1/2"	128	53	33	116	35	0,980
612126	63	10	320	84	2"	128	53	33	121	35	1,000

Other thread dimensions on request

FRIALEN safety fittings can be fused with SDR11 - SDR17.6 pipes, minimum wall thickness s minimum ≥ 3 mm. Other levels of SDR can be processed on request. Please note the mandatory labels directly on the product. DVGW test mark issued: DV-7501AU2256

Default: Brass. Gunmetal and V2A on request

WUN 90

90° transition elbow HD-PE/brass with external thread

Areas of Application

FRIALEN-Transition Elbows WUN 90° are threaded joints as an adaptor from a metal pipe with internal thread to a HD-PE pipe. Joint on the part of HD-PE by FRIALEN-Coupler.

Assembly Instructions

The threaded component must be held with a spanner to prevent it twisting in the HD-PE component. The fusion of the HD-PE side takes place by FRIALEN-fusing – leakproof and longitudinally strong.

The installation of the brass and the HD-PE side has to be prepared according to the general installation instructions (see "Transition Fittings with threaded connection" in "Assembly Instructions" for "FRIALEN-Safety Fittings for house connections and distribution pipes up to d 225"). This involves removing the oxide skin and cleaning the pipe ends.

Good reasons for using the FRIALEN-Transition Elbows WUN 90°:

- Compact construction
- HD-PE side with exposed heating element for optimal heat transfer
- Cold zones at the end to prevent the flow of molten material
- No holding clamps required
- Large insertion depth, extra wide fusion zones
- Brass end permanently anchored in the HD-PE and will not distort
- Self sealing patented sealing geometry without elastomer seal
- Additional barcode for tracing back the underground fitting (Traceability-Coding)