

# ASA UNI

## Spigot saddle SDR 17

Spigot saddle with outlet spigot ASA UNI, SDR 17

- For the connection of a branch pipe into PE pipes without pressure or under working pressure
- Compact component made of HD-PE saddle with safety technology
- Outlet spigot for processing with FRIAFIT couplers AM
- For variable adaptation to all pipe diameters in the specified range by means of clamping device
- With pin indicator for visual inspection of the fusion

### Note:

Can only be used with clamping device UNITOP (Order No. 613385) and clamping adaptor for outlet SDR 17 (Order No. 613839).

For pressure-free tapping, we recommend our drilling equipment FWAB (Order No. 613838).

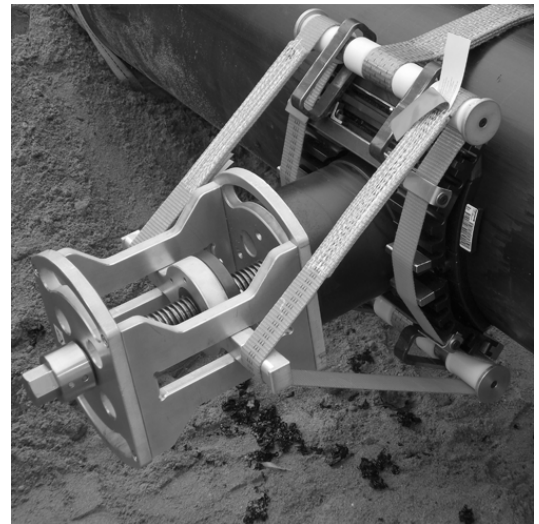
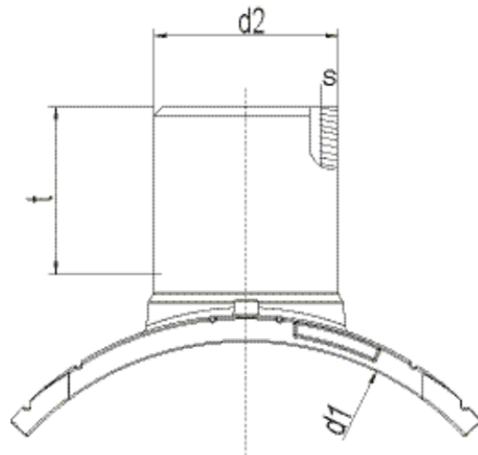

PE 100

Maximum permissible working pressure 2.5 bar (sewage)

Reference	d <sub>1</sub>	d <sub>2</sub>	BX	PU	Weight kg
682639	630-900	160	5	40	1,650

# ASA UNI

## Spigot saddle SDR 17

### Areas of Application

Instead of cost-intensively integrating a T-piece, a branch or vent can be very comfortably created using the FRIALEN spigot saddle SA-UNI. The spigot outlet can be fused with FRIALEN couplers MB or UB.

### Assembly Instructions

The saddle is clamped onto the pipe with the UNITOP clamping device (see FRIATOOLS product range). The clamping device UNITOP is an universal tool for all SA-UNI dimensions. Please read the assembly and operating instructions for the clamping device UNITOP.

The fusion of the HD-PE distribution pipes and the house connections with FRIALEN-Spigot Saddles SA-UNI takes place by FRIALEN-fusing – leakproof and longitudinally strong.

The saddle and the outlet spigot have to be prepared according to the general installation instructions (see assembly instruction FRIALEN-XL for laying large pipes and relining pipe networks). This involves removing the oxide skin and cleaning the pipe covered by the saddle.

For tapping of pipes without pressure please use the

FRIATOOLS tapping equipment FWAB XL. Please refer the assembly and operating instructions of the drilling device FWAB XL / FWAB ASA. The fusion and tapping of pipes under pressure is possible with special tapping equipment. Please contact our applications engineers.

### Good reasons for using the

#### FRIALEN Spigot Saddle SA-UNI:

- Compact construction
- HD-PE saddle with exposed heating element for optimal heat transfer
- Low tapping forces
- Burr-free and almost flush tapping for maximum hydraulic performance
- Leakage free tapping possible by means of a shut off element
- Extra wide fusion zone
- Additional barcode for tracing back the underground fitting (Traceability-Coding)
- Before tapping the pipe a leak test can take place with the pressure testing device (FWDPA SA)
- Touch proof electric contacts
- Easy and safe assembly by top-loading with the UNITOP clamping device.
- Fusion indicators for visual fusion control
- Durable batch marking
- Individually wrapped for dirt protection