

# WRKR

## Wide-Range-Reducer

Wide-Range is the same as MaxiFit.

Reducing coupling for connecting pipes made of different materials (steel, cast iron, ductile cast iron, asbestos cement, PVC, PE-HD/PEX).

- Housing and follower ring made of steel
- Rilsan corrosion protection (min. 250  $\mu\text{m}$  according to GSK)
- Screws and nuts galvanized/sheraplex-coated or made of stainless steel
- Seal material EPDM
- Diameter tolerance max. 17 mm
- Pipes can be angled by max. 6 degrees

### Note:

Our SHVA inner support sleeve is required for use on PE-HD/PEX pipes Alternatively, we recommend the longitudinally force-locking product FRIAGRIP.

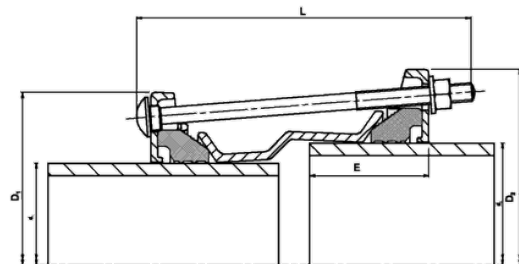

Nuts and bolts galvanized and sheraplex coated Gasket EPDM, DIN-EN 681-1 / KTW / UBA / DVGW-W270

PFA /PN Water: up to DN 300 = 16 bar

Reference	d <sub>1</sub>	d <sub>2</sub>	DN	BX	L	Weight kg
GB-99R9-315351	315,0-332,0	351,0-368,0	300	1	230	44,000
GB-99R9-315367	315,0-332,0	367,0-384,0	300	1	230	22,300
GB-99R9-351374	351,0-368,0	374,5-391,5	350	1	300	32,400
GB-99R9-374394	374,5-391,5	394,3-411,3	350	1	300	34,500
GB-99R9-374404	374,5-391,5	404,8-421,8	350	1	300	36,500
GB-99R9-394418	394,3-411,3	418,2-435,2	350	1	300	36,500

## Wide-Range-Reducer

Reference	d <sub>1</sub>	d <sub>2</sub>	DN	BX	L	Weight kg
GB-99R9-394425	394,3-411,3	425,0-442,0	350	1	300	35,600
GB-99R9-404425	404,8-421,8	425,0-442,0	400	1	300	38,800
GB-99R9-425434	425,0-442,0	434,4-451,4	400	1	300	38,900
GB-99R9-425447	425,0-442,0	447,0-464,0	400	1	300	39,100
GB-99R9-425455	425,0-442,0	455,0-472,0	400	1	300	39,500
GB-99R9-425476	425,0-442,0	476,0-493,0	400	1	300	39,500
GB-99R9-425487	425,0-442,0	487,0-504,0	400	1	300	68,000
GB-99R9-447455	447,2-464,2	455,0-472,0	400	1	300	49,500
GB-99R9-447476	447,2-464,2	476,0-493,0	400	1	300	43,000
GB-99R9-447501	447,2-464,2	501,9-518,9	400	1	300	43,000
GB-99R9-447510	447,2-464,2	510,0-527,0	400	1	300	43,600
GB-99R9-447540	447,2-464,2	540,1-557,1	400	1	300	47,400
GB-99R9-476487	476,0-493,0	487,3-504,3	400	1	300	42,700
GB-99R9-476501	476,0-493,0	501,9-518,9	400	1	300	43,000
GB-99R9-476510	476,0-493,0	510,0-527,0	400	1	300	43,600
GB-99R9-487527	487,0-504,0	527,0-544,0	400	1	300	47,700
GB-99R9-501527	501,0-518,0	527,0-545,0	500	1	300	47,700
GB-99R9-510527	510,0-527,0	527,0-545,0	500	1	300	47,700
GB-99R9-528540	527,0-544,0	540,1-557,1	500	1	300	47,400
GB-99R9-528555	527,0-544,0	555,3-572,3	500	1	300	47,600
GB-99R9-528566	527,0-544,0	566,5-583,5	500	1	300	47,800
GB-99R9-528582	527,0-544,0	582,2-599,2	500	1	300	48,000
GB-99R9-527598	527,0-544,0	598,0-615,0	500	1	300	48,000
GB-99R9-527601	527,0-544,0	601,0-618,0	500	1	300	48,000
GB-99R9-527630	527,0-544,0	630,0-647,0	500	1	300	48,000
GB-99R9-555566	555,3-572,3	566,5-583,5	500	1	300	47,800
GB-99R9-598630	598,0-615,0	630,0-647,0	600	1	300	56,100
GB-99R9-601630	601,0-618,0	630,0-647,0	600	1	300	56,100
GB-99R9-630645	630,0-647,0	645,2-662,2	600	1	300	55,800
GB-99R9-630662	630,0-647,0	662,0-679,0	600	1	300	56,100
GB-99R9-630675	630,0-647,0	675,0-692,0	600	1	300	57,000

Nuts and Bolts Stainless steel ,Gasket EPDM, DIN-EN 681-1 / KTW / UBA / DVGW-W270

PFA /PN Water: up to DN 300 = 16 bar

## Wide-Range-Reducer

Reference	d <sub>1</sub>	d <sub>2</sub>	DN	BX	L	Weight kg
GB-99R9X315351	315,0-332,0	351,0-368,0	300	1	230	32,100
GB-99R9X315367	315,0-332,0	367,0-384,0	300	1	230	22,300
GB-99R9X351374	351,0-368,0	374,5-391,5	350	1	300	34,200
GB-99R9X374394	374,5-391,5	394,3-411,3	350	1	300	34,500
GB-99R9X374404	374,5-391,5	404,8-421,8	350	1	300	36,500
GB-99R9X394418	394,3-411,3	418,2-435,2	350	1	300	36,500
GB-99R9X394425	394,3-411,3	425,0-442,0	350	1	300	37,500
GB-99R9X404425	404,8-421,8	425,0-442,0	400	1	300	37,500
GB-99R9X425434	425,0-442,0	434,4-451,4	400	1	300	38,900
GB-99R9X425447	425,0-442,0	447,0-464,0	400	1	300	39,100
GB-99R9X425455	425,0-442,0	455,0-472,0	400	1	300	39,500
GB-99R9X425476	425,0-442,0	476,0-493,0	400	1	300	55,000
GB-99R9X425487	425,0-442,0	487,0-504,0	400	1	300	68,000
GB-99R9X447455	447,2-464,2	455,0-472,0	400	1	300	39,500
GB-99R9X447476	447,2-464,2	476,0-493,0	400	1	300	43,000
GB-99R9X447501	447,2-464,2	501,9-518,9	400	1	300	43,000
GB-99R9X447510	447,2-464,2	510,0-527,0	400	1	300	43,600
GB-99R9X447540	447,2-464,2	540,1-557,1	400	1	300	47,400
GB-99R9X476487	476,0-493,0	487,3-504,3	400	1	300	42,700
GB-99R9X476501	476,0-493,0	501,9-518,9	400	1	300	43,000
GB-99R9X476510	476,0-493,0	510,0-527,0	400	1	300	43,600
GB-99R9X487527	487,0-504,0	527,0-545,0	400	1	300	47,700
GB-99R9X501527	501,0-518,0	527,0-545,0	500	1	300	47,700
GB-99R9X510527	510,0-527,0	527,0-545,0	500	1	300	47,700
GB-99R9X528540	527,0-544,0	540,1-557,1	500	1	300	47,400
GB-99R9X528555	527,0-544,0	555,3-572,1	500	1	300	47,600
GB-99R9X528566	527,0-544,0	566,5-583,5	500	1	300	47,800
GB-99R9X528582	527,0-544,0	582,2-599,2	500	1	300	48,000
GB-99R9X527598	527,0-544,0	598,0-615,0	500	1	300	63,000
GB-99R9X527601	527,0-544,0	601,0-618,0	500	1	300	48,000
GB-99R9X527630	527,0-544,0	630,0-647,0	500	1	300	48,000
GB-99R9X555566	555,3-572,3	566,5-583,5	500	1	300	47,800
GB-99R9X598630	598,0-615,0	630,0-647,0	600	1	300	56,100
GB-99R9X601630	601,0-618,0	630,0-647,0	600	1	300	56,100
GB-99R9X630645	630,0-647,0	645,2-662,2	600	1	300	55,800
GB-99R9X630662	630,0-647,0	662,0-679,0	600	1	300	56,100

# WRKR

## Wide-Range-Reducer

Reference	d <sub>1</sub>	d <sub>2</sub>	DN	BX	L	Weight kg
GB-99R9X630675	630,0-647,0	675,0-692,0	600	1	300	57,000