

Pipe tempered

Drainage pipe d40-315 mm according to EN 1519 for application in buildings, d110-315 mm for burried pipe application according EN 12666.

S= pipe class.

A (cm^{2<>}) = cross sectional area of flow.

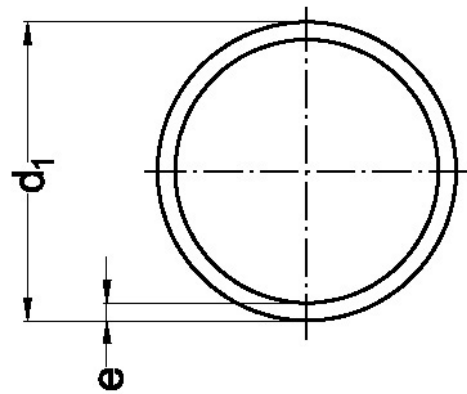

Reference	Name	tooltImage	q	Kg	d1	S	e	aCm2	Kg / m
10 04 00	Pipe tempered	-	1130	0,356	40	12,5	3,0	9,1	0,36
10 05 00	Pipe tempered	-	745	0,453	50	12,5	3,0	15,2	0,45
10 06 00	Pipe tempered	-	440	0,579	63	12,5	3,0	25,5	0,58
10 07 00	Pipe tempered	-	315	0,696	75	12,5	3,0	37,4	0,70
10 09 00	Pipe tempered	-	470	0,001	90	12,5	3,5	54,1	0,98
10 11 00	Pipe tempered	-	340	1,431	110	12,5	4,2	80,7	1,43
10 12 00	Pipe tempered	-	260	1,841	125	12,5	4,8	104,2	1,85
10 16 00	Pipe tempered	-	135	3,040	160	12,5	6,2	171,1	3,04
10 20 10	Pipe tempered	-	90	4,692	200	12,5	7,7	267,6	4,69
10 25 10	Pipe tempered	-	55	7,296	250	12,5	9,6	418,4	7,30
10 31 10	Pipe tempered	-	40	11,582	315	12,5	12,1	664,2	11,60
10 56 00	Pipe tempered	-	580	0,511	56	12,5	3,0	19,6	0,51