

Snap socketWith protection plug

1 sealing ring
2 snap ring
The snap socket can be used as a plug-in connection and a pull tight connection. The snap ring (besides the rubber sealing ring) provides the possibility to make a pull tight connection between pipe and snap socket, provided that a groove is cut into the pipe with a groove cutter (see chapter Tools). The pipe end should be pushed into the snap socket entirely. Butt-weld only

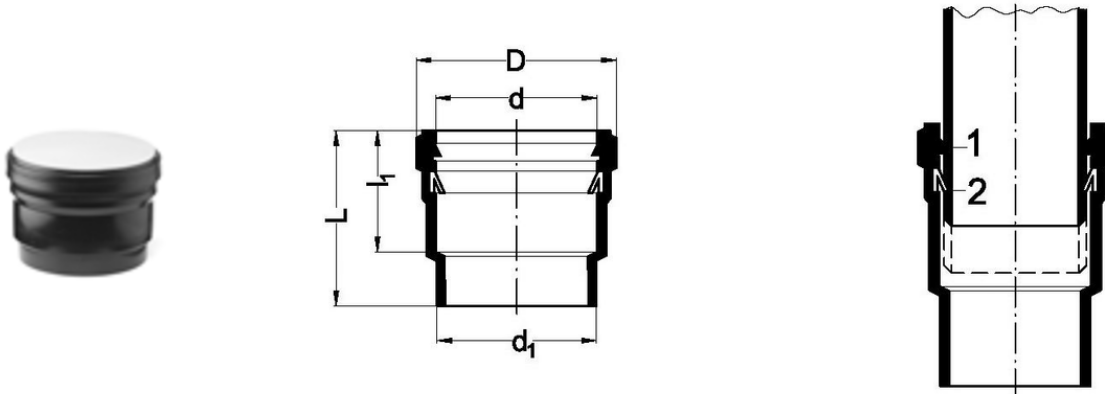

Reference	Name	tooltiplmage	d1	Kg	D	d	L	l1	noteEnum	noteText
400410	Snap socketWith protection plug	-	40	0,04	55	41	73	55	1	SBR seal 1
400510	Snap socketWith protection plug	-	50	0,048	65	51	77	55	1	SBR seal 1
400610	Snap socketWith protection plug	-	63	0,074	78	64	90	70	1	SBR seal 1
400710	Snap socketWith protection plug	-	75	0,086	90	76	90	70	1	SBR seal 1
400910	Snap socketWith protection plug	-	90	0,116	110	91	90	70	1	SBR seal 1
401110	Snap socketWith protection plug	-	110	0,16	130	111	90	70	1	SBR seal 1
401210	Snap socketWith protection plug	-	125	0,209	150	126	94	70	1	SBR seal 1
401610	Snap socketWith protection plug	-	160	0,482	190	162	134	105	1	SBR seal 1
402010	Snap socketWith protection plug	-	200	0,859	230	202	155	125	1	SBR seal 1

¹ SBR seal