

Stub flange

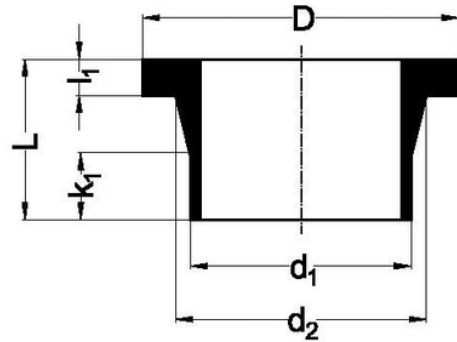

Reference	Name	tooltImage	d1	d2	Kg	D	L	noteEnum	noteText	
470402	Stub flange	-	40	50	0,064	78	50	1	butt-weld only	1
470502	Stub flange	-	50	61	0,078	88	50	1	butt-weld only	1
470602	Stub flange	-	63	75	0,106	102	50	1	butt-weld only	1
470702	Stub flange	-	75	89	0,161	120	50	1	butt-weld only	1
470902	Stub flange	-	90	105	0,239	136	80	-	butt-weld only	
471102	Stub flange	-	110	125	0,32	158	80	-	butt-weld only	
471202	Stub flange	-	125	132	0,287	158	80	-	butt-weld only	
471602	Stub flange	-	160	175	0,552	210	80	1	butt-weld only	1
472002	Stub flange	-	200	232	0,98	268	100	1	butt-weld only	1
472502	Stub flange	-	250	285	1,43	320	100	1	butt-weld only	1
473102	Stub flange	-	315	335	1,65	370	100	1	butt-weld only	1
475602	Stub flange	-	56	70	0,106	102	60	1	butt-weld only	1

¹ butt-weld only