

# OAB – Flange ANSI series

Steel core backing ring, PP/FRP coated according to ANSI B16.5 cl.150 for stubs QRNM and GRAM.

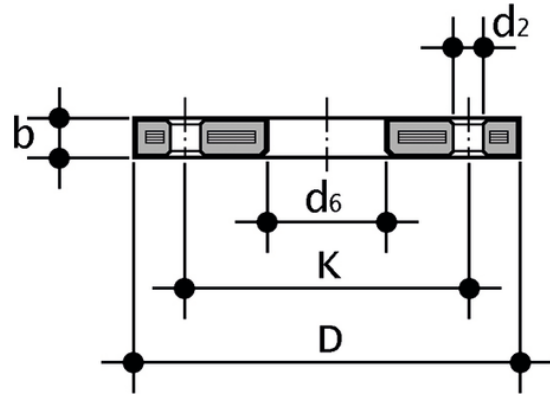

Reference	tooltiplmage	product.detail.attribute.textBelowTableText	system	Category	d (inch)	DN	*PMA (bar)	b	d <sub>2</sub> mm	d[5:2] inch	d <sub>6</sub>	D
OAB012	-	* MPA: maximum admissible working pressure **nominal tightening torque	Special parts and accessories	Flanges	1/2"	15	16	12	16	5/8"	28	95
OAB034	-	* MPA: maximum admissible working pressure **nominal tightening torque	Special parts and accessories	Flanges	3/4"	20	16	12	16	5/8"	34	102
OAB100	-	* MPA: maximum admissible working pressure **nominal tightening torque	Special parts and accessories	Flanges	1"	25	16	16	16	5/8"	42	114
OAB114	-	* MPA: maximum admissible working pressure **nominal tightening torque	Special parts and accessories	Flanges	1 1/4"	32	16	16	16	5/8"	51	130
OAB112	-	* MPA: maximum admissible working pressure **nominal tightening torque	Special parts and accessories	Flanges	1 1/2"	40	16	18	16	5/8"	62	133
OAB200	-	* MPA: maximum admissible working pressure **nominal tightening torque	Special parts and accessories	Flanges	2"	50	16	18	20	3/4"	78	162
OAB212	-	* MPA: maximum admissible working pressure **nominal tightening torque	Special parts and accessories	Flanges	2 1/2"	65	16	18	20	3/4"	92	184
OAB300	-	* MPA: maximum admissible working pressure **nominal tightening torque	Special parts and accessories	Flanges	3"	80	16	18	20	3/4"	111	194



# OAB – Flange ANSI series

Reference	tooltipImage	product.detail.attribute.textBelowTableText	system	Category	d (inch)	DN	*PMA (bar)	b	d <sub>2</sub> mm	d <sub>[5:2]</sub> inch	d <sub>6</sub>	D
OAB400	-	* MPA: maximum admissible working pressure **nominal tightening torque	Special parts and accessories	Flanges	4"	100	16	18	20	3/4"	133	229