

OABC - Flange ANSI series

Steel core blind flange, PP/FRP coated, according to ANSI B16.5 cl.150.

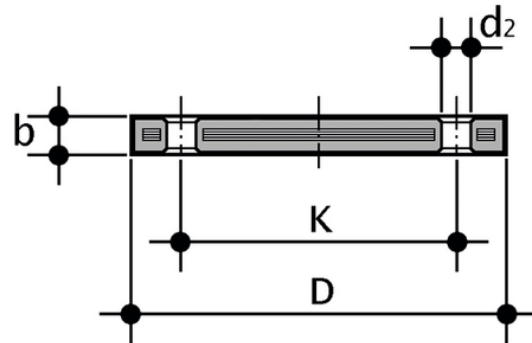

| Reference | tooltiplmage | product.detail.attribute.textBelowTableText | system | Category | d (inch) | DN | *PMA (bar) | B | D | d ₂ mm | d[5:2] inch | k(m) |
|-----------|--------------|--|-------------------------------|----------|----------|----|------------|----|-----|-------------------|-------------|------|
| OABC012 | - | * MPA: maximum admissible working pressure **nominal tightening torque all resale products | Special parts and accessories | Flanges | 1/2" | 15 | 16 | 12 | 95 | 16 | 5/8" | 60,4 |
| OABC034 | - | * MPA: maximum admissible working pressure **nominal tightening torque all resale products | Special parts and accessories | Flanges | 3/4" | 20 | 16 | 12 | 102 | 16 | 5/8" | 69,8 |
| OABC100 | - | * MPA: maximum admissible working pressure **nominal tightening torque all resale products | Special parts and accessories | Flanges | 1" | 25 | 16 | 16 | 114 | 16 | 5/8" | 79,2 |
| OABC114 | - | * MPA: maximum admissible working pressure **nominal tightening torque all resale products | Special parts and accessories | Flanges | 1 1/4" | 32 | 16 | 16 | 130 | 16 | 5/8" | 88,9 |
| OABC112 | - | * MPA: maximum admissible working pressure **nominal tightening torque all resale products | Special parts and accessories | Flanges | 1 1/2" | 40 | 16 | 18 | 133 | 16 | 5/8" | 98,5 |
| OABC200 | - | * MPA: maximum admissible working pressure **nominal tightening torque all resale products | Special parts and accessories | Flanges | 2" | 50 | 16 | 18 | 162 | 20 | 3/4" | 120, |
| OABC212 | - | * MPA: maximum admissible working pressure **nominal tightening torque all resale products | Special parts and accessories | Flanges | 2 1/2" | 65 | 16 | 18 | 184 | 20 | 3/4" | 139, |
| OABC300 | - | * MPA: maximum admissible working pressure **nominal tightening torque all resale products | Special parts and accessories | Flanges | 3" | 80 | 16 | 18 | 194 | 20 | 3/4" | 152, |



OABC - Flange ANSI series

| Reference | tooltipImage | product.detail.attribute.textBelowTableText | system | Category | d (inch) | DN | *PMA (bar) | B | D | d ₂ mm | d[5:2] inch | k(m) |
|-----------|--------------|--|-------------------------------|----------|----------|-----|------------|----|-----|-------------------|-------------|------|
| OABC400 | - | * MPA: maximum admissible working pressure **nominal tightening torque all resale products | Special parts and accessories | Flanges | 4" | 100 | 16 | 18 | 229 | 20 | 3/4" | 190, |