

ODB - Flange ISO-DIN series

Steel core backing ring, PP/FRP coated, according to EN/ISO/DIN for stub QRNM. Drilling: PN 10/16.

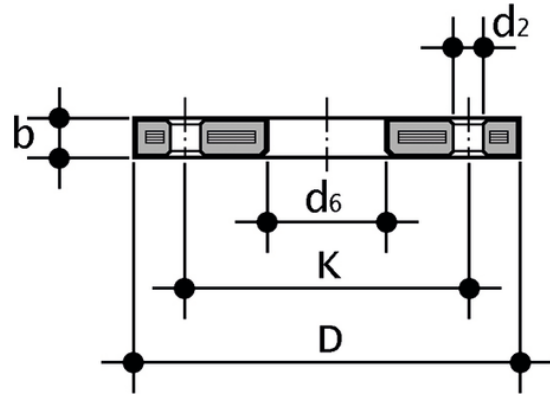

Reference	tooltiplmage	product.detail.attribute.textBelowTableText	system	Category	d	DN	*PMA (bar)	b	d ₂	d ₆	D	K
ODB020	-	PMA maximum admissible working pressure **nominal tightening torque n = number of bolts *resale products	Special parts and accessories	Flanges	20	15	16	12	14	28	95	65
ODB025	-	PMA maximum admissible working pressure **nominal tightening torque n = number of bolts *resale products	Special parts and accessories	Flanges	25	20	16	14	14	34	105	75
ODB032	-	PMA maximum admissible working pressure **nominal tightening torque n = number of bolts *resale products	Special parts and accessories	Flanges	32	25	16	14	14	42	115	85
ODB040	-	PMA maximum admissible working pressure **nominal tightening torque n = number of bolts *resale products	Special parts and accessories	Flanges	40	32	16	16	18	51	140	100
ODB050	-	PMA maximum admissible working pressure **nominal tightening torque n = number of bolts *resale products	Special parts and accessories	Flanges	50	40	16	16	18	62	150	110
ODB063	-	PMA maximum admissible working pressure **nominal tightening torque n = number of bolts *resale products	Special parts and accessories	Flanges	63	50	16	19	18	78	165	125
ODB075	-	PMA maximum admissible working pressure **nominal tightening torque n = number of bolts *resale products	Special parts and accessories	Flanges	75	65	16	19	18	92	185	145
ODB090	-	PMA maximum admissible working pressure **nominal tightening torque n = number of bolts *resale products	Special parts and accessories	Flanges	90	80	16	21	18	108	200	160



ODB - Flange ISO-DIN series

Reference	tooltiplmage	product.detail.attribute.textBelowTableText	system	Category	d	DN	*PMA (bar)	b	d ₂	d ₆	D	K
ODB110	-	PMA maximum admissible working pressure **nominal tightening torque n = number of bolts *resale products	Special parts and accessories	Flanges	110	100	16	22	18	128	220	180
ODB125	-	PMA maximum admissible working pressure **nominal tightening torque n = number of bolts *resale products	Special parts and accessories	Flanges	125	100	16	22	18	135	220	180
ODB140	-	PMA maximum admissible working pressure **nominal tightening torque n = number of bolts *resale products	Special parts and accessories	Flanges	140	125	16	26	18	158	250	210
ODB160	-	PMA maximum admissible working pressure **nominal tightening torque n = number of bolts *resale products	Special parts and accessories	Flanges	160	150	16	27	22	178	285	240
ODB180	-	PMA maximum admissible working pressure **nominal tightening torque n = number of bolts *resale products	Special parts and accessories	Flanges	180	150	16	27	22	191	285	240
ODB200	-	PMA maximum admissible working pressure **nominal tightening torque n = number of bolts *resale products	Special parts and accessories	Flanges	200	200	16	28	22	235	340	295
ODB225	-	PMA maximum admissible working pressure **nominal tightening torque n = number of bolts *resale products	Special parts and accessories	Flanges	225	200	16	28	22	238	340	295
ODB250	-	PMA maximum admissible working pressure **nominal tightening torque n = number of bolts *resale products	Special parts and accessories	Flanges	250	250	16	31	22	288	406	350
ODB280	-	PMA maximum admissible working pressure **nominal tightening torque n = number of bolts *resale products	Special parts and accessories	Flanges	280	250	16	31	22	294	406	350
ODB315	-	PMA maximum admissible working pressure **nominal tightening torque n = number of bolts *resale products	Special parts and accessories	Flanges	315	300	16	34	22	338	460	400
ODB355	-	PMA maximum admissible working pressure **nominal tightening torque n = number of bolts *resale products	Special parts and accessories	Flanges	*355	350	16	39	23	377	520	460
ODB400	-	PMA maximum admissible working pressure **nominal tightening torque n = number of bolts *resale products	Special parts and accessories	Flanges	*400	400	16	43	27	430	580	515
ODB450	-	PMA maximum admissible working pressure **nominal tightening torque n = number of bolts *resale products	Special parts and accessories	Flanges	*450	450	10	44	26	516	670	620
ODB500	-	PMA maximum admissible working pressure **nominal tightening torque n = number of bolts *resale products	Special parts and accessories	Flanges	*500	500	10	45	26	533	678	620
ODB560	-	PMA maximum admissible working pressure **nominal tightening torque n = number of bolts *resale products	Special parts and accessories	Flanges	*560	600	10	50	30	618	790	725





ODB - Flange ISO-DIN series

Reference	tooltipImage	product.detail.attribute.textBelowTableText	system	Category	d	DN	*PMA (bar)	b	d ₂	d ₆	D	K
ODB630	-	PMA maximum admissible working pressure **nominal tightening torque n = number of bolts *resale products	Special parts and accessories	Flanges	*630	600	10	50	30	645	790	725