

ODBC - Flange ISO-DIN series

Steel core blind flange, PP/FRP according to EN/ISO/DIN. Drilling: PN 10/16.

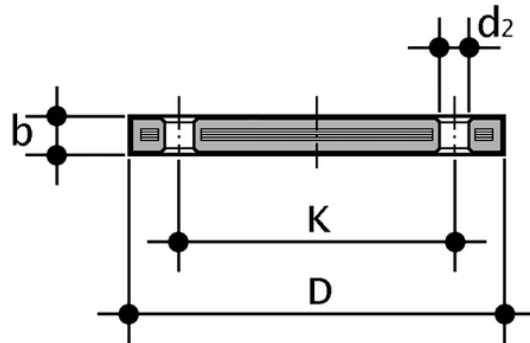

Reference	tooltipImage	product.detail.attribute.textBelowTableText	system	Category	d	DN	PMA (bar)	b	d ₂	D	k	M
ODBC020	-	PMA maximum admissible working pressure **nominal tightening torque *resale products	Special parts and accessories	Flanges	20	15	10	16	14	95	65	M12
ODBC025	-	PMA maximum admissible working pressure **nominal tightening torque *resale products	Special parts and accessories	Flanges	25	20	10	12	18	105	75	M12
ODBC032	-	PMA maximum admissible working pressure **nominal tightening torque *resale products	Special parts and accessories	Flanges	32	25	10	18	14	115	85	M12
ODBC040	-	PMA maximum admissible working pressure **nominal tightening torque *resale products	Special parts and accessories	Flanges	40	32	10	17	18	140	100	M16
ODBC050	-	PMA maximum admissible working pressure **nominal tightening torque *resale products	Special parts and accessories	Flanges	50	40	10	18	18	150	110	M16
ODBC063	-	PMA maximum admissible working pressure **nominal tightening torque *resale products	Special parts and accessories	Flanges	63	50	10	18	18	165	125	M16
ODBC075	-	PMA maximum admissible working pressure **nominal tightening torque *resale products	Special parts and accessories	Flanges	75	65	10	18	18	185	145	M16
ODBC090	-	PMA maximum admissible working pressure **nominal tightening torque *resale products	Special parts and accessories	Flanges	90	80	10	20	18	200	160	M16



ODBC - Flange ISO-DIN series

Reference	tooltipImage	product.detail.attribute.textBelowTableText	system	Category	d	DN	PMA (bar)	b	d ₂	D	k	M
ODBC110	-	PMA maximum admissible working pressure **nominal tightening torque *resale products	Special parts and accessories	Flanges	110	100	10	20	18	220	180	M16
ODBC125	-	PMA maximum admissible working pressure **nominal tightening torque *resale products	Special parts and accessories	Flanges	125	100	10	20	18	220	180	M16
ODBC140	-	PMA maximum admissible working pressure **nominal tightening torque *resale products	Special parts and accessories	Flanges	*140	125	10	24	18	250	210	M16
ODBC160	-	PMA maximum admissible working pressure **nominal tightening torque *resale products	Special parts and accessories	Flanges	160	150	10	22	22	285	240	M20
ODBC180	-	PMA maximum admissible working pressure **nominal tightening torque *resale products	Special parts and accessories	Flanges	180	150	10	24	22	285	240	M20
ODBC200	-	PMA maximum admissible working pressure **nominal tightening torque *resale products	Special parts and accessories	Flanges	200	200	10	24	22	340	295	M20
ODBC225	-	PMA maximum admissible working pressure **nominal tightening torque *resale products	Special parts and accessories	Flanges	225	200	10	24	22	340	295	M20
ODBC250	-	PMA maximum admissible working pressure **nominal tightening torque *resale products	Special parts and accessories	Flanges	250	250	10	30	22	395	350	M20
ODBC280	-	PMA maximum admissible working pressure **nominal tightening torque *resale products	Special parts and accessories	Flanges	280	250	10	30	22	395	350	M20
ODBC315	-	PMA maximum admissible working pressure **nominal tightening torque *resale products	Special parts and accessories	Flanges	315	300	10	34	22	445	400	M20
ODBC355	-	PMA maximum admissible working pressure **nominal tightening torque *resale products	Special parts and accessories	Flanges	*350	350	10	39	22	505	460	M20
ODBC400	-	PMA maximum admissible working pressure **nominal tightening torque *resale products	Special parts and accessories	Flanges	*400	400	10	46	25	574	515	M24

