

# SVUIV - Relief valve DN 15:25

Relief valve with unionised metric plain socket ends for solvent welding.

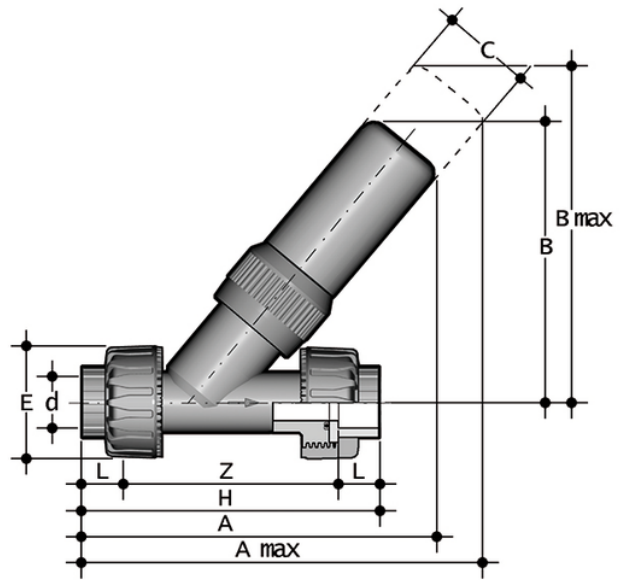

## EPDM

Reference	tooltiplmage	system	Category	family	series	d	DN	A	A max	B	B max	C	E	H	L	Z	g
SVUIV020E	-	PVC-U system	Manual valves	Auxiliary valves	SV DN 15÷25	20	15	153	193	118	170	34	55	135	16	103	391
SVUIV025E	-	PVC-U system	Manual valves	Auxiliary valves	SV DN 15÷25	25	20	191	271	150	220	40	66	158	19	120	633
SVUIV032E	-	PVC-U system	Manual valves	Auxiliary valves	SV DN 15÷25	32	25	226	296	175	230	48	75	176	22	132	1106

## FKM

Reference	tooltiplmage	system	Category	family	series	d	DN	A	A max	B	B max	C	E	H	L	Z	g
SVUIV020F	-	PVC-U system	Manual valves	Auxiliary valves	SV DN 15÷25	20	15	153	193	118	170	34	55	135	16	103	391
SVUIV025F	-	PVC-U system	Manual valves	Auxiliary valves	SV DN 15÷25	25	20	191	271	150	220	40	66	158	19	120	633
SVUIV032F	-	PVC-U system	Manual valves	Auxiliary valves	SV DN 15÷25	32	25	226	296	175	230	48	75	176	22	132	1106



## SVUIV – Relief valve DN 15:25

- Whenever upstream pressure exceeds the level at which the spring is calibrated by the user, the valve will open under the pressure of the fluid, lowering pressure on the line and thereby protecting the components in the system. The valve automatically closes again when the operating pressure on the piston drops to the value to which the spring is calibrated
- Metal parts isolated from fluid and from the environment
- Designed to permit easy installation and adjustment