

SXE-SSE DN 10÷50



Easyfit True Union ball and spring check valve



SXE-SSE DN 10÷50

The Easyfit check valve line developed with Giugiaro Design offers two different versions: SXE with ball shutter and SSE with spring loaded shutter. Easyfit check valves stand out for the innovative installation method that guarantees reliable service over time. This valve is also equipped with the customisable Labelling System.



EASYFIT TRUE UNION BALL AND SPRING CHECK VALVE

- Connection system for solvent weld and threaded joints
- **Valve material compatibility (PVC-U)** with water conveyance, drinking water and other food substances according to current regulations
- **PN16 True Union** valve body made for PVC-U injection moulding and European Directive 2014/68/EU (PED) compliant for pressurised equipment. ISO 9393 compliant test requirements
- **Short face to face dimension** according to international regulation ISO 7508 series III and European regulation EN 1452 "short" and fully interchangeable with VXE and VEE DN 10÷50 ball valve models
- Union nuts with rack for tightening adjustment via Easyfit handle or via Easy-torque adjustment kit (available as accessories)
- **Vertical** (preferable for SXE model) and **horizontal installation** potential

Technical specifications

| | |
|------------------------------|--|
| Construction | SXE: Easyfit True Union ball check valve with locked carrier. SSE: Easyfit True Union spring check valve |
| Size range | DN 10 ÷ 50 |
| Nominal pressure | PN 16 with water at 20 °C |
| Temperature range | 0 °C ÷ 60 °C |
| Coupling standards | Solvent welding: EN ISO 1452, EN ISO 15493, BS 4346-1, NF T54-028, ASTM D 2467, JIS K 6743. Pipe coupling capacity according to EN ISO 1452, EN ISO 15493, DIN 8062, NF T54-016, ASTM D 1785, JIS K 6741. Thread: ISO 228-1, EN 10226-1/2, ASTM D 2464, JIS B 0203. |
| Reference standards | Criteri Costruttivi: EN ISO 16137, EN ISO 1452, EN ISO 15493 Metodi e requisiti dei test: ISO 9393 Installation criteria: DVS 2204, DVS 2221, UNI 11242 |
| Valve material | PVC-U |
| Seal material | EPDM, FKM |
| Spring material (SSE) | Available in STAINLESS steel 316, Hastelloy C276, A316 PTFE encapsulated (DN 32, DN 40 and DN 50 only) |

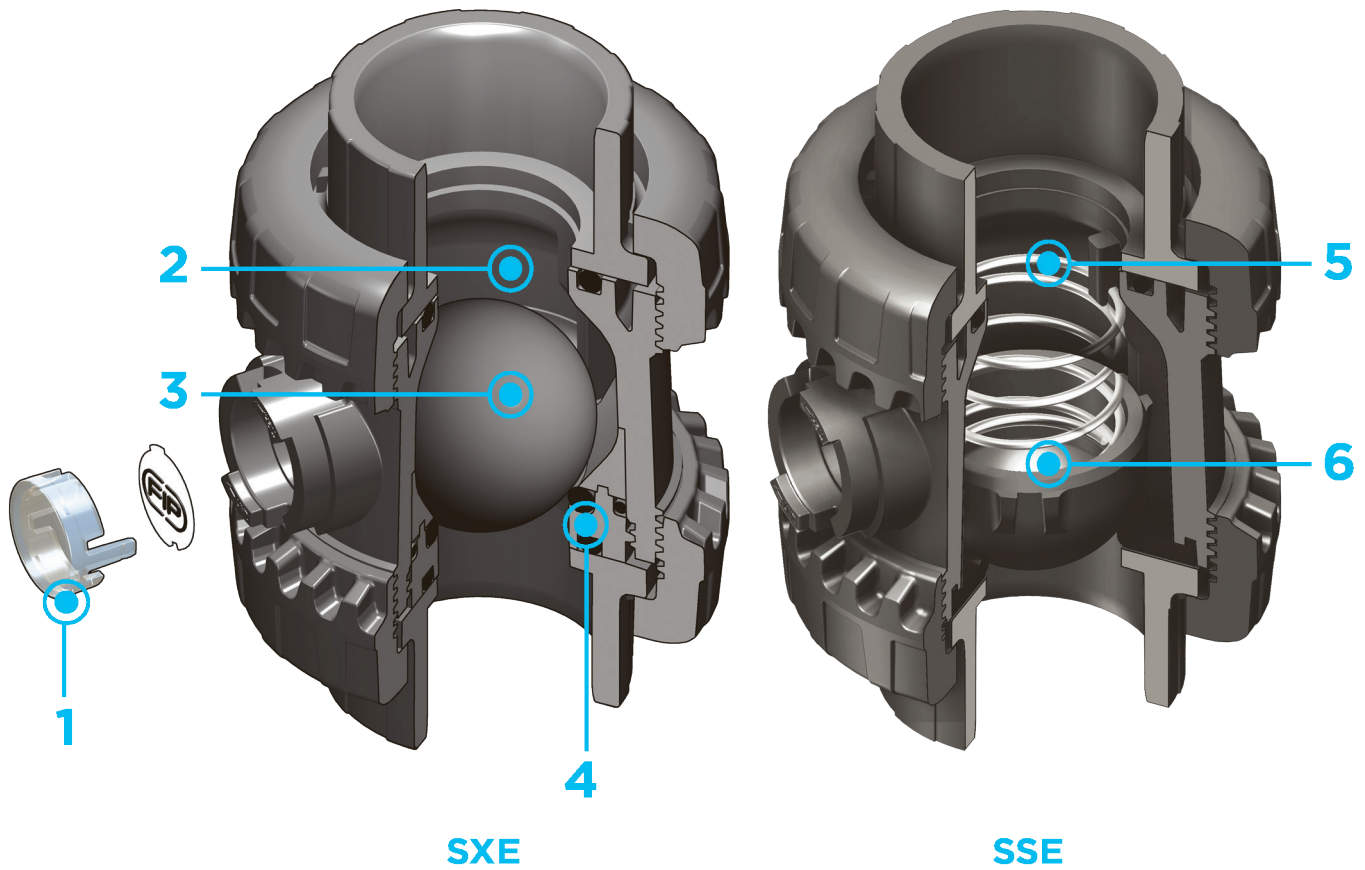

- 1 **Customisable Labelling System: built-in LCE module** on the valve body made up of transparent protection plug and customisable tag holder using the LSE set (available as accessory). The customisation potential lets you identify the valve on the system according to specific needs.
- 2 **Optimised dynamic fluid design:** energy savings thanks to the improved valve Kv value with consequent pressure drop

- reduction
- 3 High surface finish ball shutter: **wear reduction**, increase in working life and reduced valve maintenance. Ideal for conveying dirty fluids, even with suspended solids and filaments thanks to the special design that permits **internal valve selfcleaning**
 - 4 **Locked ball seat carrier:** safe dismantling for maintenance with the Easyfit multifunctional handle

- or Easytorque kit
- 5 Ideal for horizontal installations: **perfect seal even with low back pressure. Silent** and durable even with strong vibrations and pulsating fluid
 - 6 PVC-U shutter and springs available made of STAINLESS steel 316, Hastelloy C276, A316 PTFE encapsulated: maximum reliability in a **wide field of applications** from salt water to aggressive acids

TECHNICAL DATA

PRESSURE VARIATION ACCORDING TO TEMPERATURE

For water and harmless fluids to which the material is classified as CHEMICALLY RESISTANT. In other cases, a reduction of the nominal PN pressure is required (25 years with safety factor).

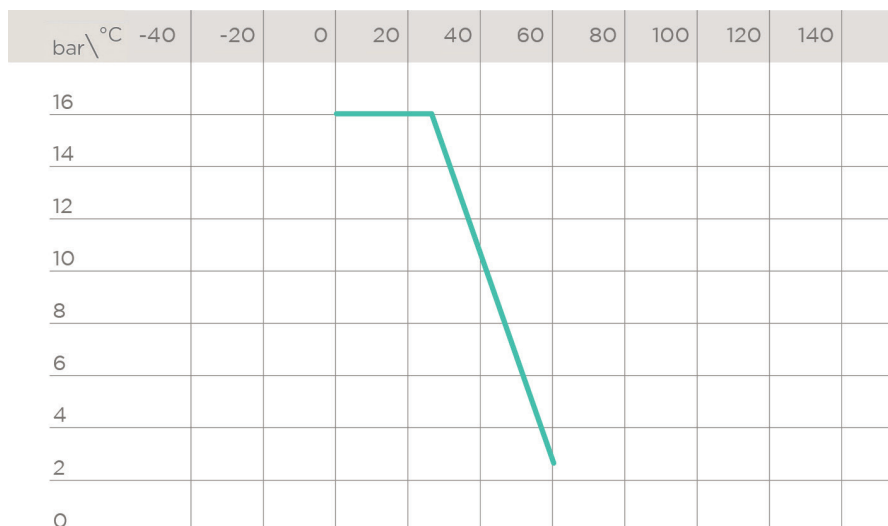

PRESSURE DROP GRAPH

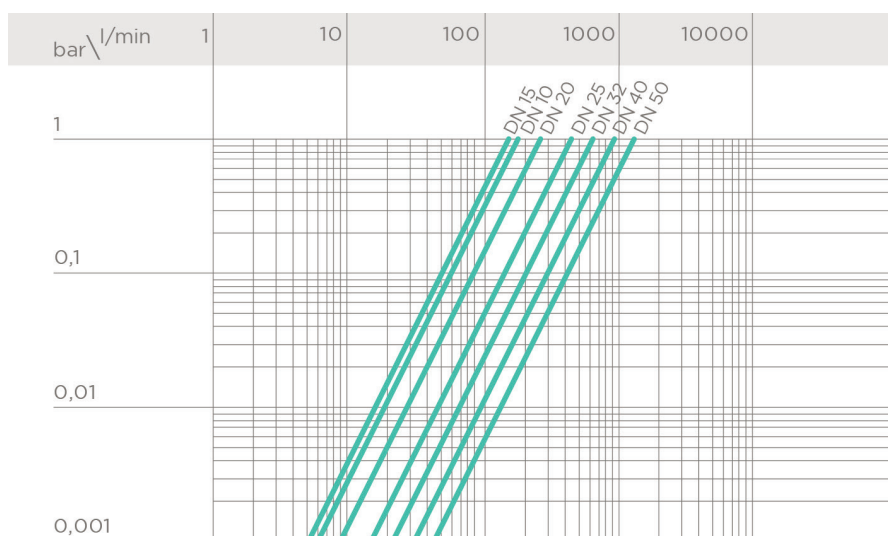

K_v100 FLOW COEFFICIENT

The K_v100 flow coefficient is the Q flow rate of litres per minute of water at a temperature of 20°C that will generate Δp= 1 bar pressure drop at a certain valve position. The Kv100 values shown in the table are calculated with the valve completely open.

| DN | 10 | 15 | 20 | 25 | 32 | 40 | 50 |
|-------------|-----|-----|-----|-----|-----|-----|------|
| Kv100 l/min | 172 | 152 | 258 | 433 | 643 | 928 | 1343 |

MINIMUM VALVE SEALING PRESSURE

The PVC-U SXE valve can only be used with liquids with specific weight under 1.37g/cm³.

| DN | 10 | 15 | 20 | 25 | 32 | 40 | 50 |
|-----------|------|------|------|------|------|------|------|
| SXE (bar) | 0,2 | 0,2 | 0,2 | 0,2 | 0,2 | 0,2 | 0,2 |
| SSE (bar) | 0,08 | 0,08 | 0,08 | 0,08 | 0,08 | 0,08 | 0,08 |

The information in this leaflet is provided in good faith. No liability will be accepted concerning technical data that is not directly covered by recognised international standards. FIP reserves the right to carry out any modification. Products must be installed and maintained by qualified personnel.

DIMENSIONS

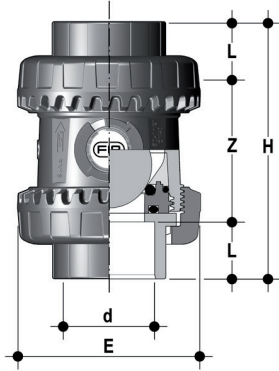

SXEIV

Easyfit ball check valve with female ends for solvent welding, metric series

| d | DN | PN | E | H | L | Z | g | EPDM code | FKM code |
|----|----|----|-----|-----|----|----|------|-----------|-----------|
| 16 | 10 | 16 | 54 | 82 | 14 | 54 | 145 | SXEIV016E | SXEIV016F |
| 20 | 15 | 16 | 54 | 82 | 16 | 50 | 148 | SXEIV020E | SXEIV020F |
| 25 | 20 | 16 | 63 | 91 | 19 | 53 | 190 | SXEIV025E | SXEIV025F |
| 32 | 25 | 16 | 72 | 103 | 22 | 59 | 300 | SXEIV032E | SXEIV032F |
| 40 | 32 | 16 | 85 | 120 | 26 | 68 | 460 | SXEIV040E | SXEIV040F |
| 50 | 40 | 16 | 100 | 139 | 31 | 77 | 675 | SXEIV050E | SXEIV050F |
| 63 | 50 | 16 | 118 | 174 | 38 | 98 | 1080 | SXEIV063E | SXEIV063F |

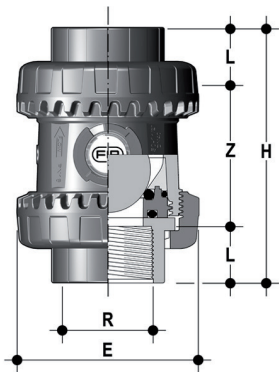

SXEFV

Easyfit ball check valve with BSP threaded female ends

| R | DN | PN | E | H | L | Z | g | EPDM code | FKM code |
|--------|----|----|-----|-----|------|-------|------|-----------|-----------|
| 3/8" | 10 | 16 | 54 | 82 | 11,4 | 59,2 | 145 | SXEFV038E | SXEFV038F |
| 1/2" | 15 | 16 | 54 | 90 | 15 | 60 | 148 | SXEFV012E | SXEFV012F |
| 3/4" | 20 | 16 | 63 | 93 | 16,3 | 60,4 | 190 | SXEFV034E | SXEFV034F |
| 1" | 25 | 16 | 72 | 110 | 19,1 | 71,8 | 300 | SXEFV100E | SXEFV100F |
| 1" 1/4 | 32 | 16 | 85 | 127 | 21,4 | 84,2 | 460 | SXEFV114E | SXEFV114F |
| 1" 1/2 | 40 | 16 | 100 | 131 | 21,4 | 88,2 | 675 | SXEFV112E | SXEFV112F |
| 2" | 50 | 16 | 118 | 161 | 25,7 | 109,6 | 1080 | SXEFV200E | SXEFV200F |

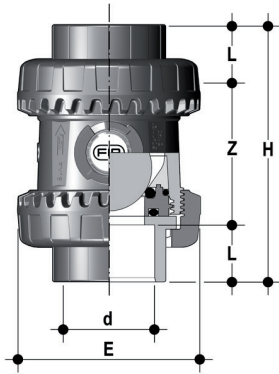

SXELV

Easyfit ball check valve with female ends for solvent welding, BS series

| d | DN | PN | E | H | L | Z | g | EPDM code | FKM code |
|--------|----|----|-----|-----|------|-----|------|-----------|-----------|
| 3/8" | 10 | 16 | 54 | 78 | 14,5 | 49 | 153 | SXELV038E | SXELV038F |
| 1/2" | 15 | 16 | 54 | 82 | 16,5 | 49 | 148 | SXELV012E | SXELV012F |
| 3/4" | 20 | 16 | 63 | 91 | 19 | 53 | 190 | SXELV034E | SXELV034F |
| 1" | 25 | 16 | 72 | 103 | 22,5 | 58 | 300 | SXELV100E | SXELV100F |
| 1 1/4" | 32 | 16 | 85 | 120 | 26 | 68 | 460 | SXELV114E | SXELV114F |
| 1 1/2" | 40 | 16 | 100 | 139 | 30 | 79 | 675 | SXELV112E | SXELV112F |
| 2" | 50 | 16 | 118 | 174 | 36 | 102 | 1080 | SXELV200E | SXELV200F |

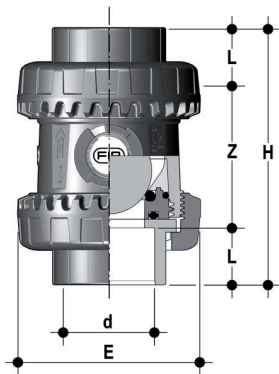

SXEAV

Easyfit ball check valve with female ends for solvent welding, ASTM series

| d | DN | PN | E | H | L | Z | g | EPDM code | FKM code |
|--------|----|----|-----|-----|------|------|------|-----------|-----------|
| 1/2" | 15 | 16 | 54 | 96 | 22,5 | 51 | 148 | SXEAV012E | SXEAV012F |
| 3/4" | 20 | 16 | 63 | 105 | 25,5 | 54 | 190 | SXEAV034E | SXEAV034F |
| 1" | 25 | 16 | 72 | 117 | 28,7 | 59,5 | 300 | SXEAV100E | SXEAV100F |
| 1 1/4" | 32 | 16 | 85 | 136 | 32 | 72 | 460 | SXEAV114E | SXEAV114F |
| 1 1/2" | 40 | 16 | 100 | 147 | 35 | 77 | 675 | SXEAV112E | SXEAV112F |
| 2" | 50 | 16 | 118 | 174 | 38,2 | 97,6 | 1080 | SXEAV200E | SXEAV200F |

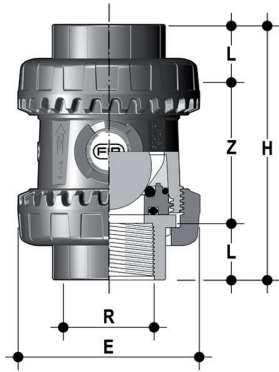

SXENV

Easyfit ball check valve with female ends, NPT thread

| R | DN | PN | E | H | L | Z | g | EPDM code | FKM code |
|--------|----|----|-----|-----|------|-------|------|-----------|-----------|
| 3/8" | 10 | 16 | 54 | 82 | 13,7 | 54,6 | 145 | SXENV038E | SXENV038F |
| 1/2" | 15 | 16 | 54 | 90 | 17,8 | 54,4 | 148 | SXENV012E | SXENV012F |
| 3/4" | 20 | 16 | 63 | 93 | 18 | 57 | 190 | SXENV034E | SXENV034F |
| 1" | 25 | 16 | 72 | 110 | 22,6 | 64,8 | 300 | SXENV100E | SXENV100F |
| 1 1/4" | 32 | 16 | 85 | 127 | 25,1 | 76,8 | 460 | SXENV114E | SXENV114F |
| 1 1/2" | 40 | 16 | 100 | 131 | 24,7 | 81,6 | 675 | SXENV112E | SXENV112F |
| 2" | 50 | 16 | 118 | 161 | 29,6 | 101,8 | 1080 | SXENV200E | SXENV200F |

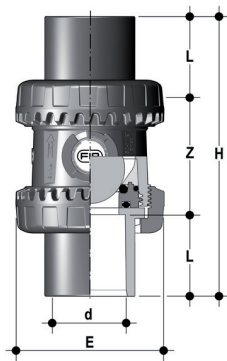

SXEJV

Easyfit ball check valve with female ends for solvent welding, JIS series

| d | DN | PN | E | H | L | Z | g | EPDM code | FKM code |
|--------|----|----|-----|-----|----|-----|------|-----------|-----------|
| 1/2" | 15 | 16 | 54 | 110 | 30 | 50 | 160 | SXEJV012E | SXEJV012F |
| 3/4" | 20 | 16 | 63 | 123 | 35 | 53 | 235 | SXEJV034E | SXEJV034F |
| 1" | 25 | 16 | 72 | 139 | 40 | 59 | 325 | SXEJV100E | SXEJV100F |
| 1 1/4" | 32 | 16 | 85 | 156 | 44 | 68 | 490 | SXEJV114E | SXEJV114F |
| 1 1/2" | 40 | 16 | 100 | 187 | 55 | 77 | 680 | SXEJV112E | SXEJV112F |
| 2" | 50 | 16 | 118 | 228 | 63 | 102 | 1150 | SXEJV200E | SXEJV200F |

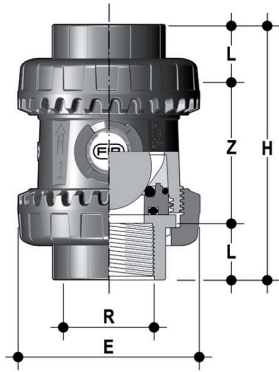

SXEGV

Easyfit ball check valve with female ends, JIS thread

| R | DN | PN | E | H | L | Z | g | EPDM code | FKM code |
|--------|----|----|-----|-----|----|-----|------|-----------|-----------|
| 1/2" | 15 | 16 | 54 | 82 | 16 | 50 | 148 | SXEGV012E | SXEGV012F |
| 3/4" | 20 | 16 | 63 | 91 | 19 | 53 | 190 | SXEGV034E | SXEGV034F |
| 1" | 25 | 16 | 72 | 103 | 22 | 59 | 300 | SXEGV100E | SXEGV100F |
| 1 1/4" | 32 | 16 | 85 | 120 | 25 | 70 | 460 | SXEGV114E | SXEGV114F |
| 1 1/2" | 40 | 16 | 100 | 139 | 26 | 87 | 675 | SXEGV112E | SXEGV112F |
| 2" | 50 | 16 | 118 | 174 | 31 | 112 | 1080 | SXEGV200E | SXEGV200F |



SXEBEV

Easyfit ball check valve with PE100 SDR 11 male ends for butt welding or electrofusion welding (CVDE)

| d | DN | PN | E | H | L | Z | g | EPDM code | FKM code |
|----|----|----|-----|-----|------|-----|------|------------|------------|
| 20 | 15 | 16 | 54 | 154 | 40,5 | 73 | 150 | SXEDEV020E | SXEDEV020F |
| 25 | 20 | 16 | 63 | 189 | 54 | 81 | 225 | SXEDEV025E | SXEDEV025F |
| 32 | 25 | 16 | 72 | 203 | 56 | 91 | 310 | SXEDEV032E | SXEDEV032F |
| 40 | 32 | 16 | 85 | 221 | 56 | 109 | 485 | SXEDEV040E | SXEDEV040F |
| 50 | 40 | 16 | 100 | 246 | 60,5 | 125 | 700 | SXEDEV050E | SXEDEV050F |
| 63 | 50 | 16 | 118 | 276 | 65,5 | 145 | 1150 | SXEDEV063E | SXEDEV063F |

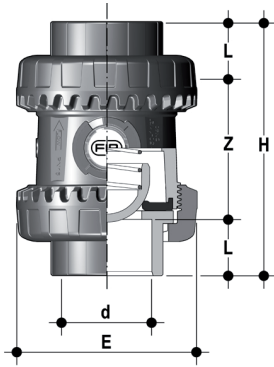

SSEIV - A316 Spring

Easyfit spring check valve with female ends for solvent welding, metric series

| d | DN | PN | E | H | L | Z | g | EPDM code | FKM code |
|----|----|----|-----|-----|----|----|------|-----------|-----------|
| 16 | 10 | 16 | 54 | 82 | 14 | 54 | 146 | SSEIV016E | SSEIV016F |
| 20 | 15 | 16 | 54 | 82 | 16 | 50 | 149 | SSEIV020E | SSEIV020F |
| 25 | 20 | 16 | 63 | 91 | 19 | 53 | 188 | SSEIV025E | SSEIV025F |
| 32 | 25 | 16 | 72 | 103 | 22 | 59 | 292 | SSEIV032E | SSEIV032F |
| 40 | 32 | 16 | 85 | 120 | 26 | 68 | 445 | SSEIV040E | SSEIV040F |
| 50 | 40 | 16 | 100 | 139 | 31 | 77 | 640 | SSEIV050E | SSEIV050F |
| 63 | 50 | 16 | 118 | 174 | 38 | 98 | 1010 | SSEIV063E | SSEIV063F |

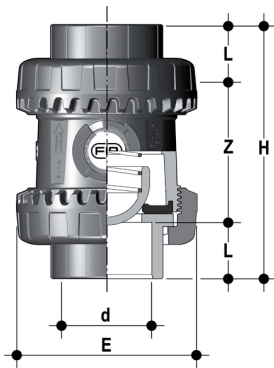

SSEIV - Hastelloy Spring

Easyfit spring check valve with female ends for solvent welding, metric series

| d | DN | PN | E | H | L | Z | g | EPDM code | FKM code |
|----|----|----|----|-----|----|----|-----|------------|------------|
| 16 | 10 | 16 | 54 | 82 | 14 | 54 | 146 | SSEIV016EH | SSEIV016FH |
| 20 | 15 | 16 | 54 | 82 | 16 | 50 | 149 | SSEIV020EH | SSEIV020FH |
| 25 | 20 | 16 | 63 | 91 | 19 | 53 | 188 | SSEIV025EH | SSEIV025FH |
| 32 | 25 | 16 | 72 | 103 | 22 | 59 | 292 | SSEIV032EH | SSEIV032FH |

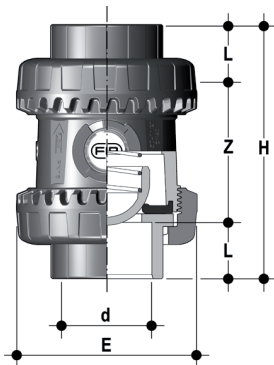

SSEIV - A316/PTFE encapsulated Spring

Easyfit spring check valve with female ends for solvent welding, metric series

| d | DN | PN | E | H | L | Z | g | EPDM code | FKM code |
|----|----|----|-----|-----|----|----|------|-------------|-------------|
| 40 | 32 | 16 | 85 | 120 | 26 | 68 | 445 | SSEIV040EOP | SSEIV040FOP |
| 50 | 40 | 16 | 100 | 139 | 31 | 77 | 640 | SSEIV050EOP | SSEIV050FOP |
| 63 | 50 | 16 | 118 | 174 | 38 | 98 | 1010 | SSEIV063EOP | SSEIV063FOP |

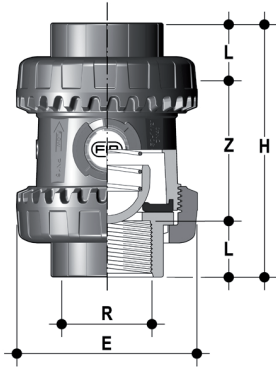

SSEFV - A316 Spring

Easyfit spring check valve with BSP threaded female ends

| R | DN | PN | E | H | L | Z | g | EPDM code | FKM code |
|--------|----|----|-----|-----|------|-------|------|-----------|-----------|
| 3/8" | 10 | 16 | 54 | 82 | 11,4 | 59,2 | 146 | SSEFV038E | SSEFV038F |
| 1/2" | 15 | 16 | 54 | 90 | 15 | 60 | 149 | SSEFV012E | SSEFV012F |
| 3/4" | 20 | 16 | 63 | 93 | 16,3 | 60,4 | 188 | SSEFV034E | SSEFV034F |
| 1" | 25 | 16 | 72 | 110 | 19,1 | 71,8 | 292 | SSEFV100E | SSEFV100F |
| 1" 1/4 | 32 | 16 | 85 | 127 | 21,4 | 84,2 | 445 | SSEFV114E | SSEFV114F |
| 1" 1/2 | 40 | 16 | 100 | 131 | 21,4 | 88,2 | 640 | SSEFV112E | SSEFV112F |
| 2" | 50 | 16 | 118 | 161 | 25,7 | 109,6 | 1010 | SSEFV200E | SSEFV200F |

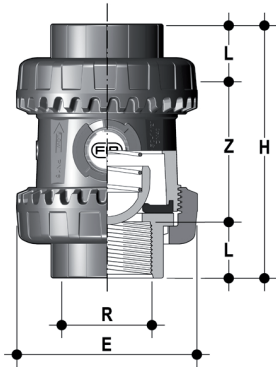

SSEFV - Hastelloy Spring

Easyfit spring check valve with BSP threaded female ends

| R | DN | PN | E | H | L | Z | g | EPDM code | FKM code |
|------|----|----|----|-----|------|------|-----|------------|------------|
| 3/8" | 10 | 16 | 54 | 82 | 11,4 | 59,2 | 146 | SSEFV038EH | SSEFV038FH |
| 1/2" | 15 | 16 | 54 | 90 | 15 | 60 | 149 | SSEFV012EH | SSEFV012FH |
| 3/4" | 20 | 16 | 63 | 93 | 16,3 | 60,4 | 188 | SSEFV034EH | SSEFV034FH |
| 1" | 25 | 16 | 72 | 110 | 19,1 | 71,8 | 292 | SSEFV100EH | SSEFV100FH |

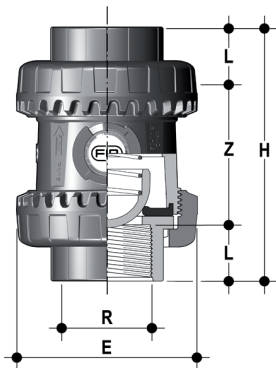

SSEFV - A316/PTFE encapsulated Spring

Easyfit spring check valve with BSP threaded female ends

| R | DN | PN | E | H | L | Z | g | EPDM code | FKM code |
|--------|----|----|-----|-----|------|-------|------|-------------|-------------|
| 1" 1/4 | 32 | 16 | 85 | 127 | 21,4 | 84,2 | 445 | SSEFV114EOP | SSEFV114FOP |
| 1" 1/2 | 40 | 16 | 100 | 131 | 21,4 | 88,2 | 640 | SSEFV112EOP | SSEFV112FOP |
| 2" | 50 | 16 | 118 | 161 | 25,7 | 109,6 | 1010 | SSEFV200EOP | SSEFV200FOP |

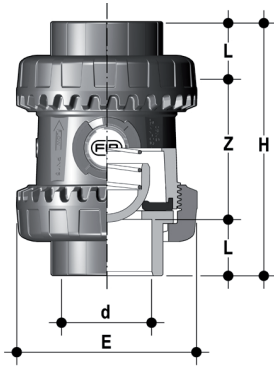

SSELV - A316 Spring

Easyfit spring check valve with female ends for solvent welding, BS series

| d | DN | PN | E | H | L | Z | g | EPDM code | FKM code |
|--------|----|----|-----|-----|------|-----|------|-----------|-----------|
| 3/8" | 10 | 16 | 54 | 78 | 14,5 | 49 | 154 | SSELV038E | SSELV038F |
| 1/2" | 15 | 16 | 54 | 82 | 16,5 | 49 | 149 | SSELV012E | SSELV012F |
| 3/4" | 20 | 16 | 63 | 91 | 19 | 53 | 188 | SSELV034E | SSELV034F |
| 1" | 25 | 16 | 72 | 103 | 22,5 | 58 | 292 | SSELV100E | SSELV100F |
| 1" 1/4 | 32 | 16 | 85 | 120 | 26 | 68 | 445 | SSELV114E | SSELV114F |
| 1" 1/2 | 40 | 16 | 100 | 139 | 30 | 79 | 640 | SSELV112E | SSELV112F |
| 2" | 50 | 16 | 118 | 174 | 36 | 102 | 1010 | SSELV200E | SSELV200F |

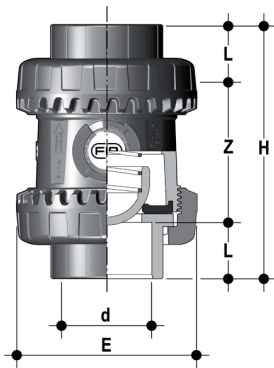

SSELV - Hastelloy Spring

Easyfit spring check valve with female ends for solvent welding, BS series

| d | DN | PN | E | H | L | Z | g | EPDM code | FKM code |
|------|----|----|----|-----|------|----|-----|------------|------------|
| 3/8" | 10 | 16 | 54 | 78 | 14,5 | 49 | 154 | SSELV038EH | SSELV038FH |
| 1/2" | 15 | 16 | 54 | 82 | 16,5 | 49 | 149 | SSELV012EH | SSELV012FH |
| 3/4" | 20 | 16 | 63 | 91 | 19 | 53 | 188 | SSELV034EH | SSELV034FH |
| 1" | 25 | 16 | 72 | 103 | 22,5 | 58 | 292 | SSELV100EH | SSELV100FH |

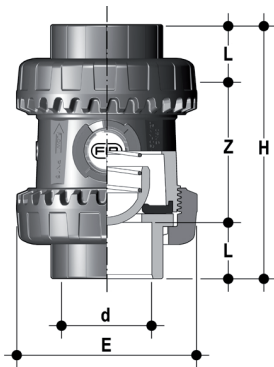

SSELV - A316/PTFE encapsulated Spring

Easyfit spring check valve with female ends for solvent welding, BS series

| d | DN | PN | E | H | L | Z | g | EPDM code | FKM code |
|--------|----|----|-----|-----|----|-----|------|-------------|-------------|
| 1" 1/4 | 32 | 16 | 85 | 120 | 26 | 68 | 445 | SSELV114EOP | SSELV114FOP |
| 1" 1/2 | 40 | 16 | 100 | 139 | 30 | 79 | 640 | SSELV112EOP | SSELV112FOP |
| 2" | 50 | 16 | 118 | 174 | 36 | 102 | 1010 | SSELV200EOP | SSELV200FOP |

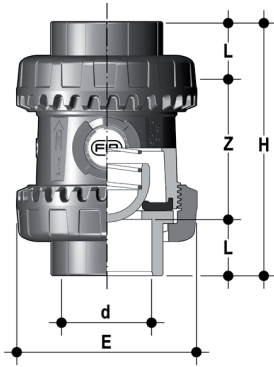

SSEIV

Easyfit spring check valve with female ends for solvent welding, metric series

| d | DN | PN | E | H | L | Z | g | EPDM code | FKM code |
|----|----|----|-----|-----|----|----|------|-----------|-----------|
| 16 | 10 | 16 | 54 | 82 | 14 | 54 | 146 | SSEIV016E | SSEIV016F |
| 20 | 15 | 16 | 54 | 82 | 16 | 50 | 149 | SSEIV020E | SSEIV020F |
| 25 | 20 | 16 | 63 | 91 | 19 | 53 | 188 | SSEIV025E | SSEIV025F |
| 32 | 25 | 16 | 72 | 103 | 22 | 59 | 292 | SSEIV032E | SSEIV032F |
| 40 | 32 | 16 | 85 | 120 | 26 | 68 | 445 | SSEIV040E | SSEIV040F |
| 50 | 40 | 16 | 100 | 139 | 31 | 77 | 640 | SSEIV050E | SSEIV050F |
| 63 | 50 | 16 | 118 | 174 | 38 | 98 | 1010 | SSEIV063E | SSEIV063F |

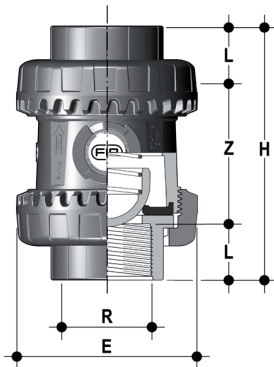

SSEFV

Easyfit spring check valve with BSP threaded female ends

| R | DN | PN | E | H | L | Z | g | EPDM code | FKM code |
|--------|----|----|-----|-----|------|-------|------|-----------|-----------|
| 3/8" | 10 | 16 | 54 | 82 | 11,4 | 59,2 | 146 | SSEFV038E | SSEFV038F |
| 1/2" | 15 | 16 | 54 | 90 | 15 | 60 | 149 | SSEFV012E | SSEFV012F |
| 3/4" | 20 | 16 | 63 | 93 | 16,3 | 60,4 | 188 | SSEFV034E | SSEFV034F |
| 1" | 25 | 16 | 72 | 110 | 19,1 | 71,8 | 292 | SSEFV100E | SSEFV100F |
| 1" 1/4 | 32 | 16 | 85 | 127 | 21,4 | 84,2 | 445 | SSEFV114E | SSEFV114F |
| 1" 1/2 | 40 | 16 | 100 | 131 | 21,4 | 88,2 | 640 | SSEFV112E | SSEFV112F |
| 2" | 50 | 16 | 118 | 161 | 25,7 | 109,6 | 1010 | SSEFV200E | SSEFV200F |

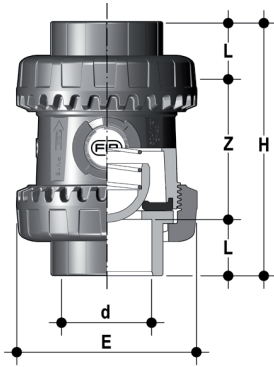

SSELV

Easyfit spring check valve with female ends for solvent welding, BS series

| d | DN | PN | E | H | L | Z | g | EPDM code | FKM code |
|--------|----|----|-----|-----|------|-----|------|-----------|-----------|
| 3/8" | 10 | 16 | 54 | 78 | 14,5 | 49 | 154 | SSELV038E | SSELV038F |
| 1/2" | 15 | 16 | 54 | 82 | 16,5 | 49 | 149 | SSELV012E | SSELV012F |
| 3/4" | 20 | 16 | 63 | 91 | 19 | 53 | 188 | SSELV034E | SSELV034F |
| 1" | 25 | 16 | 72 | 103 | 22,5 | 58 | 292 | SSELV100E | SSELV100F |
| 1" 1/4 | 32 | 16 | 85 | 120 | 26 | 68 | 445 | SSELV114E | SSELV114F |
| 1" 1/2 | 40 | 16 | 100 | 139 | 30 | 79 | 640 | SSELV112E | SSELV112F |
| 2" | 50 | 16 | 118 | 174 | 36 | 102 | 1010 | SSELV200E | SSELV200F |

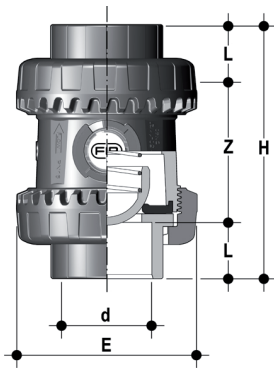

SSEAV

Easyfit spring check valve with female ends for solvent welding, ASTM series

| d | DN | PN | E | H | L | Z | g | EPDM code | FKM code |
|--------|----|----|-----|-----|------|------|------|-----------|-----------|
| 1/2" | 15 | 16 | 54 | 96 | 22,5 | 51 | 149 | SSEAV012E | SSEAV012F |
| 3/4" | 20 | 16 | 63 | 105 | 25,5 | 54 | 188 | SSEAV034E | SSEAV034F |
| 1" | 25 | 16 | 72 | 117 | 28,7 | 59,5 | 292 | SSEAV100E | SSEAV100F |
| 1" 1/4 | 32 | 16 | 85 | 136 | 32 | 72 | 445 | SSEAV114E | SSEAV114F |
| 1" 1/2 | 40 | 16 | 100 | 147 | 35 | 77 | 640 | SSEAV112E | SSEAV112F |
| 2" | 50 | 16 | 118 | 174 | 38,2 | 97,6 | 1010 | SSEAV200E | SSEAV200F |

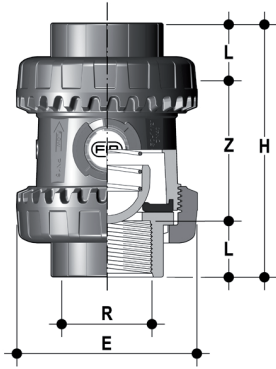

SENV

Easyfit spring check valve with female ends, NPT thread

| R | DN | PN | E | H | L | Z | g | EPDM code | FKM code |
|--------|----|----|-----|-----|------|-------|------|-----------|-----------|
| 3/8" | 10 | 16 | 54 | 82 | 13,7 | 54,6 | 146 | SSENV038E | SSENV038F |
| 1/2" | 15 | 16 | 54 | 90 | 17,8 | 54,4 | 149 | SSENV012E | SSENV012F |
| 3/4" | 20 | 16 | 63 | 93 | 18 | 57 | 188 | SSENV034E | SSENV034F |
| 1" | 25 | 16 | 72 | 110 | 22,6 | 64,8 | 292 | SSENV100E | SSENV100F |
| 1" 1/4 | 32 | 16 | 85 | 127 | 25,1 | 76,8 | 445 | SSENV114E | SSENV114F |
| 1" 1/2 | 40 | 16 | 100 | 131 | 24,7 | 81,6 | 640 | SSENV112E | SSENV112F |
| 2" | 50 | 16 | 118 | 161 | 29,6 | 101,8 | 1010 | SSENV200E | SSENV200F |

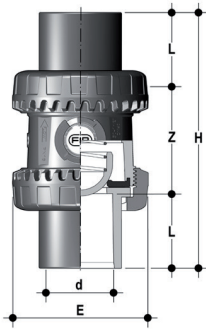

SSEJV

Easyfit spring check valve with female ends for solvent welding, JIS series

| d | DN | PN | E | H | L | Z | g | EPDM code | FKM code |
|--------|----|----|-----|-----|----|-----|------|-----------|-----------|
| 1/2" | 15 | 16 | 54 | 110 | 30 | 50 | 161 | SSEJV012E | SSEJV012F |
| 3/4" | 20 | 16 | 63 | 123 | 35 | 53 | 233 | SSEJV034E | SSEJV034F |
| 1" | 25 | 16 | 72 | 139 | 40 | 59 | 317 | SSEJV100E | SSEJV100F |
| 1" 1/4 | 32 | 16 | 85 | 156 | 44 | 68 | 475 | SSEJV114E | SSEJV114F |
| 1" 1/2 | 40 | 16 | 100 | 187 | 55 | 77 | 645 | SSEJV112E | SSEJV112F |
| 2" | 50 | 16 | 118 | 228 | 63 | 102 | 1080 | SSEJV200E | SSEJV200F |

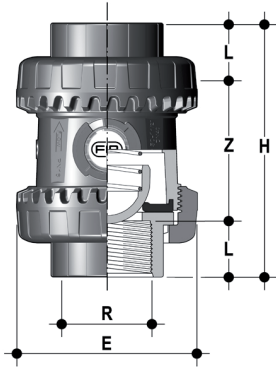

SSEGV

Easyfit spring check valve with female ends, JIS thread

| R | DN | PN | E | H | L | Z | g | EPDM code | FKM code |
|--------|----|----|-----|-----|----|-----|------|-----------|-----------|
| 1/2" | 15 | 16 | 54 | 82 | 16 | 50 | 149 | SSEGV012E | SSEGV012F |
| 3/4" | 20 | 16 | 63 | 91 | 19 | 53 | 188 | SSEGV034E | SSEGV034F |
| 1" | 25 | 16 | 72 | 103 | 22 | 59 | 292 | SSEGV100E | SSEGV100F |
| 1" 1/4 | 32 | 16 | 85 | 120 | 25 | 70 | 445 | SSEGV114E | SSEGV114F |
| 1" 1/2 | 40 | 16 | 100 | 139 | 26 | 87 | 640 | SSEGV112E | SSEGV112F |
| 2" | 50 | 16 | 118 | 174 | 31 | 112 | 1010 | SSEGV200E | SSEGV200F |

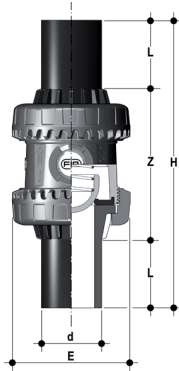

SSEBEV

Easyfit spring check valve with PE100 SDR 11 male end connectors for butt welding or electrofusion (CVDE)

| d | DN | PN | E | H | L | Z | g | EPDM code | FKM code |
|----|----|----|-----|-----|------|-----|------|------------|------------|
| 20 | 15 | 16 | 54 | 154 | 40,5 | 73 | 151 | SSEBEV020E | SSEBEV020F |
| 25 | 20 | 16 | 63 | 186 | 54 | 81 | 223 | SSEBEV025E | SSEBEV025F |
| 32 | 25 | 16 | 72 | 199 | 56 | 91 | 302 | SSEBEV032E | SSEBEV032F |
| 40 | 32 | 16 | 85 | 217 | 56 | 109 | 470 | SSEBEV040E | SSEBEV040F |
| 50 | 40 | 16 | 100 | 236 | 60,5 | 125 | 665 | SSEBEV050E | SSEBEV050F |
| 63 | 50 | 16 | 118 | 268 | 65,5 | 145 | 1080 | SSEBEV063E | SSEBEV063F |

ACCESSORIES

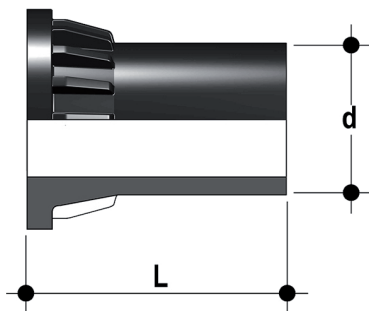

CVDE

Long spigot PE100 end connectors for joints with electrofusion fittings or for butt welding

| d | DN | PN | L | SDR | Code |
|----|----|----|----|-----|-----------|
| 20 | 15 | 16 | 55 | 11 | CVDE11020 |
| 25 | 20 | 16 | 70 | 11 | CVDE11025 |
| 32 | 25 | 16 | 74 | 11 | CVDE11032 |
| 40 | 32 | 16 | 78 | 11 | CVDE11040 |
| 50 | 40 | 16 | 84 | 11 | CVDE11050 |
| 63 | 50 | 16 | 91 | 11 | CVDE11063 |

Easyfit handle

Easyfit multifunctional handle for union nut tightening SXE-SSE DN 10÷50

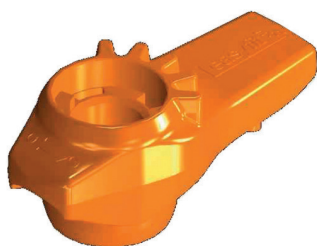

| d | DN | Code |
|---------|---------|----------|
| 16 - 20 | 10 - 15 | HAVXE020 |
| 25 | 20 | HAVXE025 |
| 32 | 25 | HAVXE032 |
| 40 | 32 | HAVXE040 |
| 52 | 40 | HAVXE050 |
| 63 | 50 | HAVXE063 |

EASYTORQUE KIT

Kit for union nut tightening adjustment and ball seat carrier for Easyfit DN 10÷50 valves.



| d | DN | Union nut tightening torque* | Seat carrier tightening torque* | Code |
|-----------|-------|------------------------------|---------------------------------|-------|
| 3/8"-1/2" | 10-15 | 5 N m - 3,69 Lbf ft | 3 N m - 2,21 Lbf ft | KET01 |
| 3/4" | 20 | 5 N m - 3,69 Lbf ft | 3 N m - 2,21 Lbf ft | KET01 |
| 1" | 25 | 6 N m - 4,43 Lbf ft | 4 N m - 2,95 Lbf ft | KET01 |
| 1" 1/4 | 32 | 7 N m - 5,16 Lbf ft | 4 N m - 2,95 Lbf ft | KET01 |
| 1" 1/2 | 40 | 8 N m - 5,90 Lbf ft | 5 N m - 3,69 Lbf ft | KET01 |
| 2" | 50 | 10 N m - 7,38 Lbf ft | 6 N m - 4,43 Lbf ft | KET01 |

*calculated in ideal installation conditions



LSE

Customisation and label printing set for Easyfit handle made up of pre-cut adhesive sheets and software for guided label creation.

| d | DN | SXE-SSE code |
|----|----|--------------|
| 16 | 10 | - |
| 20 | 15 | - |
| 25 | 20 | - |
| 32 | 25 | LSE020 |
| 40 | 32 | LSE025 |
| 50 | 40 | LSE032 |
| 63 | 50 | LSE032 |

CUSTOMISATION

Fig. 1



Fig. 2



Fig. 3



SXE and SSE DN 10÷50 Easyfit valves are equipped with a customisable Labelling System.

This system lets you create special labels to affix to the valve body. This makes it extremely easy to apply company logos, identification serial numbers or service indications such as, for example, the valve function in the system, the transported fluid, but also specific information for customer service, such as the customer name or installation date or location on the valves.

The specific LCE module is a standard supply and is made up of a rigid transparent water-resistant PVC plug and white tag holder made of the same material, one side of which bears the FIP logo (fig. 1).

The holder, inserted in the plug, can be removed and, once overturned, used for customisation by applying labels printed with the software supplied with the LSE set.

Proceed as follows to apply the label on the valve:

- 1) Extract the transparent plug from the seat on the valve body (fig. 1).
- 2) Extract the tag holder from the transparent plug (fig. 2).
- 3) Apply the adhesive label on the tag holder to align the profiles matching the tab position.
- 4) Re-insert the tag holder in the transparent plug so that the label is protected from the elements.
- 5) Replace the transparent plug in its seat on the valve body.

COMPONENTS

EXPLODED VIEW

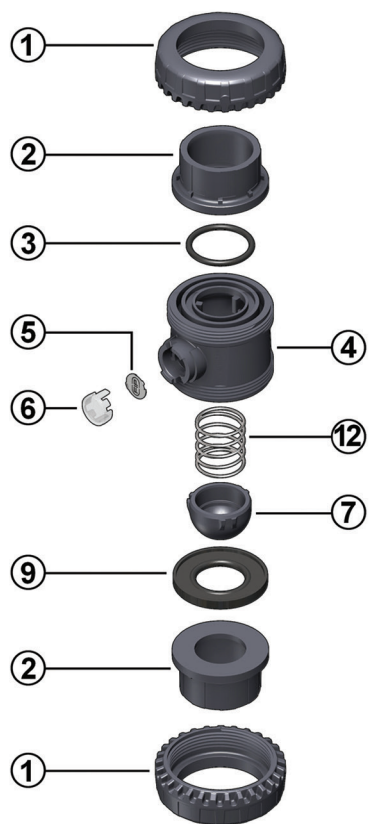

SSE

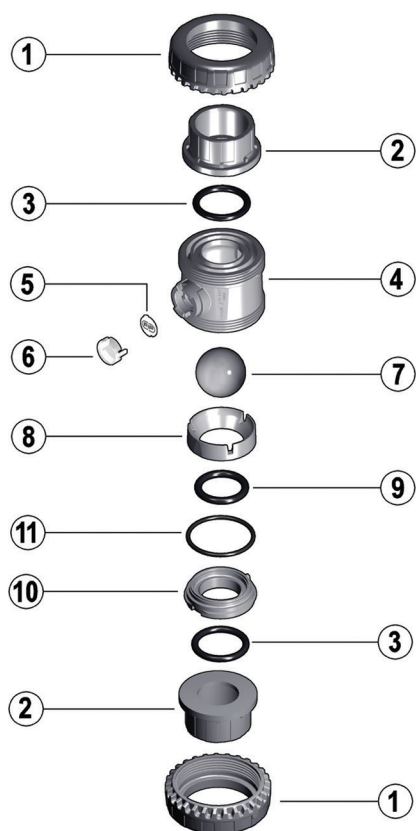

SXE

- | | | | | | |
|----------|------------------------------------|------------|---------------------------------------|------------|-----------------------------------|
| 1 | Union nut (PVC-U - 2) | 6 | Transparent protection plug (PVC - 1) | 9 | Ball seat O-Ring (EPDM, FKM - 1) |
| 2 | End connector (PVC-U - 2) | 7 | Ball (PVC-U - 1) | SXE | |
| 3 | Socket seal O-Ring (EPDM, FKM - 2) | SXE | | 9 | Shutter gasket (EPDM, FKM - 1) |
| 4 | Body (PVC-U - 1) | SSE | 7 | SSE | |
| 5 | Tag holder (PVC - 1) | SSE | 8 | 10 | Ball seat carrier (PVC-U - 1) |
| | | | | 11 | Radial seal O-Ring (EPDM,FKM - 1) |
| | | | | 12 | Spring (STAINLESS steel* - 1) |

* Also available made of Hastelloy C276 or A316 PTFE encapsulated (for DN 40 and DN 50 only)
The component material and quantity supplied are indicated in the parentheses.

DISASSEMBLY

SXE

SXE valves do not require maintenance in normal operating conditions. In the event of leaks or wear, before performing maintenance, cut-off fluid upstream from the valve and make sure it is de-pressurised (downstream drain if necessary).

- 1) Fully drain residual liquid that could be aggressive for the operator and, if possible, circulate water to internally clean the valve.
- 2) To easily unscrew the union nuts when dismantling, use the Easyfit multifunctional handle (supplied as an accessory) (fig. 4) or Easytorque kit (fig. 5-6).
- 3) Unscrew the seal carrier (10) with the Easyfit multifunctional handle (fig. 7) or Easytorque kit (fig. 8).
- 4) Remove all internal components.

SSE

In the event of leaks or wear, before performing maintenance, cut-off fluid upstream from the valve and make sure it is de-pressurised (downstream drain if necessary).

- 1) Fully drain residual liquid that could be aggressive for the operator and, if possible, circulate water to internally clean the valve.
- 2) To easily unscrew the union nuts when dismantling, use the Easyfit multifunctional handle (supplied as an accessory) (fig. 4) or Easytorque kit (fig. 5-6).
- 3) Extract the ball seat O-ring (9).
- 4) Remove all internal components.

ASSEMBLY

SXE

- 1) Reconstruct the valve following the exploded view on the previous page
- 2) Tighten the ball seat carrier (10) using the Easyfit multifunctional handle (fig. 7) or Easytorque wrench (fig. 8) according to the torque indicated in the enclosed instructions. This way valve installation and excellent operations are guaranteed
- 3) Position the valve between the end connectors (2) and tighten the union nuts clockwise (1) using the Easyfit multifunctional handle (fig. 4) or Easytorque kit (fig. 5-6), being sure the socket seal O-ring (3) does not exit the seats.

SSE

- 1) Reconstruct the valve following the exploded view on the previous page.
- 2) Position the valve between the end connectors (2) and tighten the union nuts clockwise (1) using the Easyfit multifunctional handle (fig. 4) or Easytorque kit (fig. 5-6), being sure the socket seal O-ring (3) does not exit the seats.



Note: during assembly operations, it is advisable to lubricate the rubber seals. Mineral oils are not recommended for this task as they react aggressively with EPDM rubber.

Fig. 4

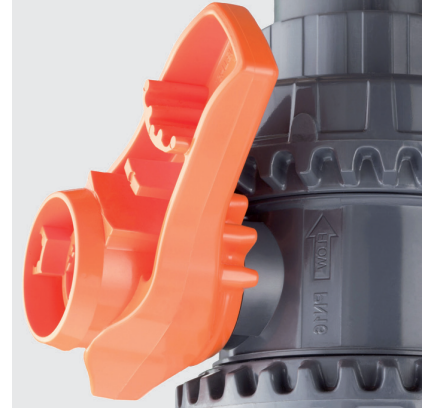

Fig. 5



Fig. 6



Fig. 7



INSTALLATION

SXE-SSE valves can be installed both vertically (upward flow) or horizontally (SXE with a minimum 0.2 bar back pressure). Before proceeding with installation, please follow these instructions carefully:

- 1) Check that the pipes to be connected to the valve are aligned in order to avoid mechanical stress on the threaded joints.
- 2) Unscrew the union nuts (1) from the body (4) and insert them in the pipe segments.
- 3) Solvent weld or screw the end connectors (2) onto the pipe segments.
- 4) Position the valve body between the end connectors (fig. 9).
- 5) Fit the union nuts on the valve body and manually tighten clockwise until they become hard to turn; do not use wrenches or other tools that can damage the union nut surfaces.
- 6) For easy union nut tightening in assembly, use the Easyfit multifunctional handle (supplied as an accessory).
- 7) Overturn the handle and insert it on the stem so the handle teeth (A) match the union nut teeth (B) (fig. 10)
- 8) Turn the handle counter-clockwise to fully tighten the union nut (fig. 10). The rotation directions to tighten (TIGHTEN) and loosen (UNTIGHTEN) the union nuts are indicated on the handle (fig. 11). Generally, if pipes are not offset, a single turn is sufficient for correct tightening.
- 9) Repeat point 7 for the other union nut. Note: A small force applied on the handle develops a torque much higher than manual tightening. You can also, using the Easytorque kit (fig. 5-6), supplied as an accessory, tighten union nuts using a torque wrench to quantify the force and thus monitor the stress applied to the thermoplastic threads according to the installation indications in the instructions enclosed with the kit.
- 10) If necessary, support pipes with FIP pipe clip model ZIKM and DSM distance plates.

WARNINGS

Do not use compressed air or other gases to test thermoplastic lines.
Always avoid sudden closing manoeuvres and protect the valve against accidental manoeuvres.
Leave a straight section of pipe of length equal to 5 times the nominal diameter before and after the valve.

Fig. 8



Fig. 9



Fig. 10



Fig. 11

